

## O-Rings: European (German) Metric Range

Items marked \* are suitable for dynamic applications

APL Code	d1	Tolerance on d1 +/-	d2	Dowty Ref	APL Code	d1	Tolerance on d1 +/-	d2	Dowty Ref
002-10	2	0.15	1.0 +/- 0.08	N/A	039-10	39	0.30	1.0 +/- 0.08	N/A
003-10	3	0.15		N/A	040-10	40	0.30		N/A
0035-10	3.5	0.15		N/A	041-10	41	0.42		N/A
004-10	4	0.15		N/A	042-10	42	0.42		N/A
005-10	5	0.15		N/A	043-10	43	0.42		N/A
006-10	6	0.15		N/A	044-10	44	0.42		N/A
007-10	7	0.15		N/A	045-10	45	0.42		N/A
008-10	8	0.15		N/A	046-10	46	0.42		N/A
009-10	9	0.15		N/A	047-10	47	0.42		N/A
010-10	10	0.15		N/A	048-10	48	0.42		N/A
011-10	11	0.2		N/A	049-10	49	0.42	N/A	
012-10	12	0.2		N/A	050-10	50	0.42	N/A	
013-10	13	0.2		N/A	003-15	3	0.15	1.5 +/- 0.08	206-003
014-10	14	0.2		N/A	004-15	4	0.15		206-004
015-10	15	0.2		N/A	005-15	5	0.15		206-005
016-10	16	0.2		N/A	006-15	6	0.15		206-006
017-10	17	0.2		N/A	007-15	7	0.15		206-007
018-10	18	0.2		N/A	008-15	8	0.15		206-008
019-10	19	0.25		N/A	009-15	9	0.15		206-009
020-10	20	0.25	N/A	010-15	10	0.20	206-010		
021-10	21	0.25	N/A	011-15	11	0.20	206-011		
022-10	22	0.25	N/A	012-15	12	0.20	206-012		
023-10	23	0.25	N/A	013-15	13	0.20	206-013		
024-10	24	0.25	N/A	014-15	14	0.20	206-014		
025-10	25	0.25	N/A	015-15	15	0.20	206-015		
026-10	26	0.25	N/A	016-15	16	0.20	206-016		
027-10	27	0.25	N/A	017-15	17	0.20	206-017		
028-10	28	0.25	N/A	018-15	18	0.20	206-018		
029-10	29	0.25	N/A	019-15	19	0.25	206-019		
030-10	30	0.25	N/A	020-15	20	0.25	206-020		
031-10	31	0.30	N/A	021-15	21	0.25	206-021		
032-10	32	0.30	N/A	022-15	22	0.25	206-022		
033-10	33	0.30	N/A	023-15	23	0.25	206-023		
034-10	34	0.30	N/A	024-15	24	0.25	206-024		
035-10	35	0.30	N/A	025-15	25	0.25	206-025		
036-10	36	0.30	N/A	026-15	26	0.25	206-026		
037-10	37	0.30	N/A	027-15	27	0.25	206-027		
038-10	38	0.30	N/A	028-15	28	0.25	206-028		

For more sizes please contact our sales team

All dimensions in mm unless stated otherwise

If a dimension is critical to your application please contact our sales department for confirmation.

Please note : errors and omissions excepted.

When ordering please specify material

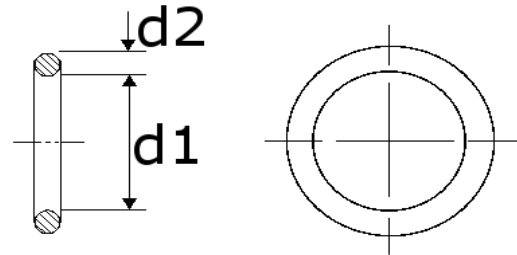

## O-Rings: European (German) Metric Range

Items marked \* are suitable for dynamic applications

APL Code	d1	Tolerance on d1 +/-	d2	Dowty Ref	APL Code	d1	Tolerance on d1 +/-	d2	Dowty Ref	
029-15	29	0.25	1.5 +/- 0.08	206-029	067-15	67	0.40	1.5 +/- 0.08	206-067	
030-15	30	0.25		206-030	068-15	68	0.40		206-068	
031-15	31	0.30		206-031	069-15	69	0.40		206-069	
032-15	32	0.30		206-032	070-15	70	0.40		206-070	
033-15	33	0.30		206-033	071-15	71	0.40		206-071	
034-15	34	0.30		206-034	072-15	72	0.40		206-072	
035-15	35	0.30		206-035	073-15	73	0.40		206-073	
036-15	36	0.30		206-036	074-15	74	0.40		206-074	
037-15	37	0.30		206-037	075-15	75	0.40		206-075	
038-15	38	0.30		206-038	076-15	76	0.40		206-076	
039-15	39	0.30		206-039	077-15	77	0.40		206-077	
040-15	40	0.30		206-040	078-15	78	0.40		206-078	
041-15	41	0.30		206-041	079-15	79	0.40		206-079	
042-15	42	0.30		206-042	080-15	80	0.40		206-080	
043-15	43	0.30		206-043	081-15	81	0.50		206-081	
044-15	44	0.30		206-044	082-15	82	0.50		206-082	
045-15	45	0.30		206-045	083-15	83	0.50		206-083	
046-15	46	0.30		206-046	084-15	84	0.50		206-084	
047-15	47	0.30		206-047	085-15	85	0.50		206-085	
048-15	48	0.30		206-048	086-15	86	0.50		206-086	
049-15	49	0.30		206-049	087-15	87	0.50		206-087	
050-15	50	0.30		206-050	088-15	88	0.50		206-088	
051-15	51	0.40		206-051	089-15	89	0.50		206-089	
052-15	52	0.40		206-052	090-15	90	0.50		206-090	
053-15	53	0.40		206-053	091-15	91	0.50		206-091	
054-15	54	0.40		206-054	092-15	92	0.50		206-092	
055-15	55	0.40		206-055	093-15	93	0.50		206-093	
056-15	56	0.40		206-056	094-15	94	0.50		206-094	
057-15	57	0.40		206-057	095-15	95	0.50		206-095	
058-15	58	0.40		206-058	096-15	96	0.50		206-096	
059-15	59	0.40		206-059	097-15	97	0.50		206-097	
060-15	60	0.40		206-060	098-15	98	0.50		206-098	
061-15	61	0.40		206-061	099-15	99	0.50		206-099	
062-15	62	0.40		206-062	100-15	100	0.50		206-100	
063-15	63	0.40		206-063	003-20*	3	0.15		2.0 +/- 0.08	204-003
064-15	64	0.40		206-064	004-20*	4	0.15			204-004
065-15	65	0.40		206-065	005-20*	5	0.15			204-005
066-15	66	0.40		206-066	006-20*	6	0.15			204-006

For more sizes please contact our sales team

All dimensions in mm unless stated otherwise

If a dimension is critical to your application please contact our sales department for confirmation.

Please note : errors and omissions excepted.

When ordering please specify material

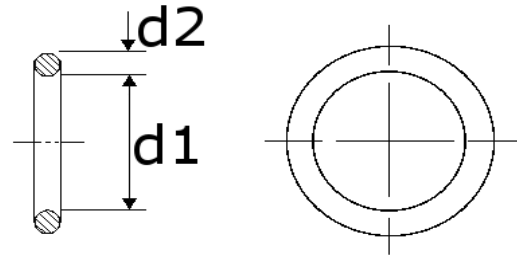

## O-Rings: European (German) Metric Range

Items marked \* are suitable for dynamic applications

APL Code	d1	Tolerance on d1 +/-	d2	Dowty Ref	APL Code	d1	Tolerance on d1 +/-	d2	Dowty Ref
007-20*	7	0.15		204-007	045-20	45	0.30		204-045
008-20*	8	0.15		204-008	046-20	46	0.30		204-046
009-20*	9	0.15		204-009	047-20	47	0.30		204-047
010-20*	10	0.20		204-010	048-20	48	0.30		204-048
011-20*	11	0.20		204-011	049-20	49	0.30		204-049
012-20*	12	0.20		204-012	050-20	50	0.30		204-050
013-20	13	0.20		204-013	051-20	51	0.40		204-051
014-20	14	0.20		204-014	052-20	52	0.40		204-052
015-20	15	0.20		204-015	053-20	53	0.40		204-053
016-20	16	0.20		204-016	054-20	54	0.40		204-054
017-20	17	0.20		204-017	055-20	55	0.40		204-055
018-20	18	0.20		204-018	056-20	56	0.40		204-056
019-20	19	0.25		204-019	057-20	57	0.40		204-057
020-20	20	0.25		204-020	058-20	58	0.40		204-058
021-20	21	0.25		204-021	059-20	59	0.40		204-059
022-20	22	0.25		204-022	060-20	60	0.40		204-060
023-20	23	0.25		204-023	061-20	61	0.40		204-061
024-20	24	0.25		204-024	062-20	62	0.40		204-062
025-20	25	0.25	2.0	204-025	063-20	63	0.40	2.0	204-063
026-20	26	0.25	+/- 0.08	204-026	064-20	64	0.40	+/- 0.08	204-064
027-20	27	0.25		204-027	065-20	65	0.40		204-065
028-20	28	0.25		204-028	066-20	66	0.40		204-066
029-20	29	0.25		204-029	067-20	67	0.40		204-067
030-20	30	0.25		204-030	068-20	68	0.40		204-068
031-20	31	0.30		204-031	069-20	69	0.40		204-069
032-20	32	0.30		204-032	070-20	70	0.40		204-070
033-20	33	0.30		204-033	071-20	71	0.40		204-071
034-20	34	0.30		204-034	072-20	72	0.40		204-072
035-20	35	0.30		204-035	073-20	73	0.40		204-073
036-20	36	0.30		204-036	074-20	74	0.40		204-074
037-20	37	0.30		204-037	075-20	75	0.40		204-075
038-20	38	0.30		204-038	076-20	76	0.40		204-076
039-20	39	0.30		204-039	077-20	77	0.40		204-077
040-20	40	0.30		204-040	078-20	78	0.40		204-078
041-20	41	0.30		204-041	079-20	79	0.40		204-079
042-20	42	0.30		204-042	080-20	80	0.40		204-080
043-20	43	0.30		204-043	081-20	81	0.50		204-081
044-20	44	0.30		204-044	082-20	82	0.50		204-082

For more sizes please contact our sales team

All dimensions in mm unless stated otherwise

If a dimension is critical to your application please contact our sales department for confirmation.

Please note : errors and omissions excepted.

When ordering please specify material

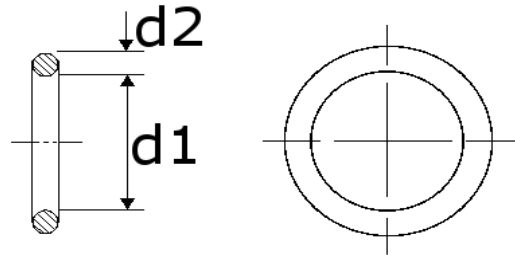

## O-Rings: European (German) Metric Range

Items marked \* are suitable for dynamic applications

APL Code	d1	Tolerance on d1 +/-	d2	Dowty Ref	APL Code	d1	Tolerance on d1 +/-	d2	Dowty Ref
083-20	83	0.50	2.0 +/- 0.08	204-083	024-25*	24	0.25	2.5 +/- 0.08	206-124
084-20	84	0.50		204-084	025-25*	25	0.25		206-125
085-20	85	0.50		204-085	026-25	26	0.25		206-126
086-20	86	0.50		204-086	027-25	27	0.25		206-127
087-20	87	0.50		204-087	028-25	28	0.25		206-128
088-20	88	0.50		204-088	029-25	29	0.25		206-129
089-20	89	0.50		204-089	030-25	30	0.25		206-130
090-20	90	0.50		204-090	031-25	31	0.30		206-131
091-20	91	0.50		204-091	032-25	32	0.30		206-132
092-20	92	0.50		204-092	033-25	33	0.30		206-133
093-20	93	0.50		204-093	034-25	34	0.30		206-134
094-20	94	0.50		204-094	035-25	35	0.30		206-135
095-20	95	0.50		204-095	036-25	36	0.30		206-136
096-20	96	0.50		204-096	037-25	37	0.30		206-137
097-20	97	0.50		204-097	038-25	38	0.30		206-138
098-20	98	0.50		204-098	039-25	39	0.30		206-139
099-20	99	0.50		204-099	040-25	40	0.30		206-140
100-20	100	0.50		204-100	041-25	41	0.30		206-141
004-25*	4	0.15		206-104	042-25	42	0.30		206-142
005-25*	5	0.15		206-105	043-25	43	0.30		206-143
006-25*	6	0.15	206-106	044-25	44	0.30	206-144		
007-25*	7	0.15	206-107	045-25	45	0.30	206-145		
008-25*	8	0.15	206-108	046-25	46	0.30	206-146		
009-25*	9	0.15	206-109	047-25	47	0.30	206-147		
010-25*	10	0.20	206-110	048-25	48	0.30	206-148		
011-25*	11	0.20	206-111	049-25	49	0.30	206-149		
012-25*	12	0.20	206-112	050-25	50	0.30	206-150		
013-25*	13	0.20	206-113	051-25	51	0.40	206-151		
014-25*	14	0.20	206-114	052-25	52	0.40	206-152		
015-25*	15	0.20	206-115	053-25	53	0.40	206-153		
016-25*	16	0.20	206-116	054-25	54	0.40	206-154		
017-25*	17	0.20	206-117	055-25	55	0.40	206-155		
018-25*	18	0.20	206-118	056-25	56	0.40	206-156		
019-25*	19	0.25	206-119	057-25	57	0.40	206-157		
020-25*	20	0.25	206-120	058-25	58	0.40	206-158		
021-25*	21	0.25	206-121	059-25	59	0.40	206-159		
022-25*	22	0.25	206-122	060-25	60	0.40	206-160		
023-25*	23	0.25	206-123	061-25	61	0.40	206-161		

For more sizes please contact our sales team

All dimensions in mm unless stated otherwise

If a dimension is critical to your application please contact our sales department for confirmation.

Please note : errors and omissions excepted.

When ordering please specify material

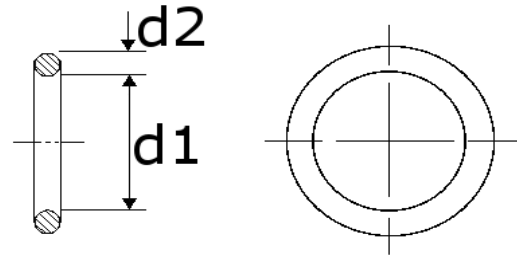

## O-Rings: European (German) Metric Range

Items marked \* are suitable for dynamic applications

APL Code	d1	Tolerance on d1 +/-	d2	Dowty Ref	APL Code	d1	Tolerance on d1 +/-	d2	Dowty Ref
062-25	62	0.40	2.5 +/- 0.08	206-162	100-25	100	0.50	2.5 +/- 0.08	206-200
063-25	63	0.40		206-163	101-25	101	0.50		206-201
064-25	64	0.40		206-164	102-25	102	0.50		206-202
065-25	65	0.40		206-165	103-25	103	0.50		206-203
066-25	66	0.40		206-166	104-25	104	0.50		206-204
067-25	67	0.40		206-167	105-25	105	0.50		206-205
068-25	68	0.40		206-168	106-25	106	0.50		206-206
069-25	69	0.40		206-169	107-25	107	0.50		206-207
070-25	70	0.40		206-170	108-25	108	0.50		206-208
071-25	71	0.40		206-171	109-25	109	0.50		206-209
072-25	72	0.40		206-172	110-25	110	0.50		206-210
073-25	73	0.40		206-173	111-25	111	0.50		206-211
074-25	74	0.40		206-174	112-25	112	0.50		206-212
075-25	75	0.40		206-175	113-25	113	0.50		206-213
076-25	76	0.40		206-176	114-25	114	0.50		206-214
077-25	77	0.40		206-177	115-25	115	0.50		206-215
078-25	78	0.40		206-178	116-25	116	0.50		206-216
079-25	79	0.40		206-179	117-25	117	0.50		206-217
080-25	80	0.40		206-180	118-25	118	0.50		206-218
081-25	81	0.50	206-181	119-25	119	0.50	206-219		
082-25	82	0.50	206-182	120-25	120	0.50	206-220		
083-25	83	0.50	206-183	121-25	121	0.50	206-221		
084-25	84	0.50	206-184	122-25	122	0.60	206-222		
085-25	85	0.50	206-185	123-25	123	0.60	206-223		
086-25	86	0.50	206-186	124-25	124	0.60	206-224		
087-25	87	0.50	206-187	125-25	125	0.60	206-225		
088-25	88	0.50	206-188	126-25	126	0.60	206-226		
089-25	89	0.50	206-189	127-25	127	0.60	206-227		
090-25	90	0.50	206-190	128-25	128	0.60	206-228		
091-25	91	0.50	206-191	129-25	129	0.60	206-229		
092-25	92	0.50	206-192	130-25	130	0.60	206-230		
093-25	93	0.50	206-193	131-25	131	0.60	206-231		
094-25	94	0.50	206-194	132-25	132	0.60	206-232		
095-25	95	0.50	206-195	133-25	133	0.60	206-233		
096-25	96	0.50	206-196	134-25	134	0.60	206-234		
097-25	97	0.50	206-197	135-25	135	0.60	206-235		
098-25	98	0.50	206-198	136-25	136	0.60	206-236		
099-25	99	0.50	206-199	137-25	137	0.60	206-237		

For more sizes please contact our sales team

All dimensions in mm unless stated otherwise

If a dimension is critical to your application please contact our sales department for confirmation.

Please note : errors and omissions excepted.

When ordering please specify material

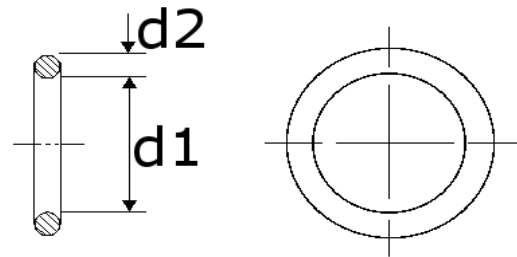

## O-Rings: European (German) Metric Range

Items marked \* are suitable for dynamic applications

APL Code	d1	Tolerance on d1 +/-	d2	Dowty Ref	APL Code	d1	Tolerance on d1 +/-	d2	Dowty Ref
138-25	138	0.60	2.5 +/- 0.08	206-238	028-30	28	0.25	3.0 +/- 0.10	206-328
139-25	139	0.60		206-239	029-30	29	0.25		206-329
140-25	140	0.60		206-240	030-30	30	0.25		206-330
141-25	141	0.60		206-241	031-30	31	0.30		206-331
142-25	142	0.60		206-242	032-30	32	0.30		206-332
143-25	143	0.60		206-243	033-30	33	0.30		206-333
144-25	144	0.60		206-244	034-30	34	0.30		206-334
145-25	145	0.60		206-245	035-30	35	0.30		206-335
146-25	146	0.60		206-246	036-30	36	0.30		206-336
147-25	147	0.60		206-247	037-30	37	0.30		206-337
148-25	148	0.60		206-248	038-30	38	0.30		206-338
149-25	149	0.60		206-249	039-30	39	0.30		206-339
150-25	150	0.60		206-250	040-30	40	0.30		206-340
003-30	3	0.15		206-303	041-30	41	0.30		206-341
004-30	4	0.15		206-304	042-30	42	0.30		206-342
005-30	5	0.15	206-305	043-30	43	0.30	206-343		
006-30	6	0.15	206-306	044-30	44	0.30	206-344		
007-30	7	0.15	206-307	045-30	45	0.30	206-345		
008-30	8	0.15	206-308	046-30	46	0.30	206-346		
009-30	9	0.15	206-309	047-30	47	0.30	206-347		
010-30	10	0.20	206-310	048-30	48	0.30	206-348		
011-30	11	0.20	206-311	049-30	49	0.30	206-349		
012-30	12	0.20	206-312	050-30	50	0.30	206-350		
013-30	13	0.20	206-313	051-30	51	0.40	206-351		
014-30	14	0.20	206-314	052-30	52	0.40	206-352		
015-30	15	0.20	206-315	053-30	53	0.40	206-353		
016-30	16	0.20	206-316	054-30	54	0.40	206-354		
017-30	17	0.20	206-317	055-30	55	0.40	206-355		
018-30	18	0.20	206-318	056-30	56	0.40	206-356		
019-30	19	0.25	206-319	057-30	57	0.40	206-357		
020-30	20	0.25	206-320	058-30	58	0.40	206-358		
021-30	21	0.25	206-321	059-30	59	0.40	206-359		
022-30	22	0.25	206-322	060-30	60	0.40	206-360		
023-30	23	0.25	206-323	061-30	61	0.40	206-361		
024-30	24	0.25	206-324	062-30	62	0.40	206-362		
025-30	25	0.25	206-325	063-30	63	0.40	206-363		
026-30	26	0.25	206-326	064-30	64	0.40	206-364		
027-30	27	0.25	206-327	065-30	65	0.40	206-365		

For more sizes please contact our sales team

All dimensions in mm unless stated otherwise

If a dimension is critical to your application please contact our sales department for confirmation.

Please note : errors and omissions excepted.

When ordering please specify material

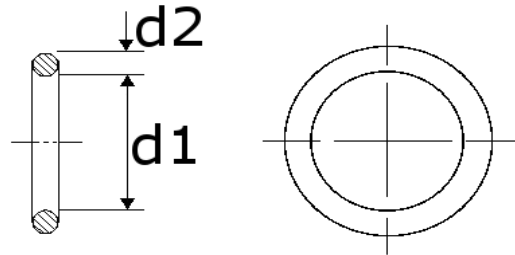

## O-Rings: European (German) Metric Range

Items marked \* are suitable for dynamic applications

APL Code	d1	Tolerance on d1 +/-	d2	Dowty Ref	APL Code	d1	Tolerance on d1 +/-	d2	Dowty Ref
066-30	66	0.40		206-366	104-30	104	0.50		206-404
067-30	67	0.40		206-367	105-30	105	0.50		206-405
068-30	68	0.40		206-368	106-30	106	0.50		206-406
069-30	69	0.40		206-369	107-30	107	0.50		206-407
070-30	70	0.40		206-370	108-30	108	0.50		206-408
071-30	71	0.40		206-371	109-30	109	0.50		206-409
072-30	72	0.40		206-372	110-30	110	0.50		206-410
073-30	73	0.40		206-373	111-30	111	0.50		206-411
074-30	74	0.40		206-374	112-30	112	0.50		206-412
075-30	75	0.40		206-375	113-30	113	0.50		206-413
076-30	76	0.40		206-376	114-30	114	0.50		206-414
077-30	77	0.40		206-377	115-30	115	0.50		206-415
078-30	78	0.40		206-378	116-30	116	0.50		206-416
079-30	79	0.40		206-379	117-30	117	0.50		206-417
080-30	80	0.40		206-380	118-30	118	0.50		206-418
081-30	81	0.50		206-381	119-30	119	0.50		206-419
082-30	82	0.50		206-382	120-30	120	0.50		206-420
083-30	83	0.50		206-383	121-30	121	0.60		206-421
084-30	84	0.50	3.0	206-384	122-30	122	0.60	3.0	206-422
085-30	85	0.50	+/- 0.10	206-385	123-30	123	0.60	+/- 0.10	206-423
086-30	86	0.50		206-386	124-30	124	0.60		206-424
087-30	87	0.50		206-387	125-30	125	0.60		206-425
088-30	88	0.50		206-388	126-30	126	0.60		206-426
089-30	89	0.50		206-389	127-30	127	0.60		206-427
090-30	90	0.50		206-390	128-30	128	0.60		206-428
091-30	91	0.50		206-391	129-30	129	0.60		206-429
092-30	92	0.50		206-392	130-30	130	0.60		206-430
093-30	93	0.50		206-393	131-30	131	0.60		206-431
094-30	94	0.50		206-394	132-30	132	0.60		206-432
095-30	95	0.50		206-395	133-30	133	0.60		206-433
096-30	96	0.50		206-396	134-30	134	0.60		206-434
097-30	97	0.50		206-397	135-30	135	0.60		206-435
098-30	98	0.50		206-398	136-30	136	0.60		206-436
099-30	99	0.50		206-399	137-30	137	0.60		206-437
100-30	100	0.50		206-400	138-30	138	0.60		206-438
101-30	101	0.50		206-401	139-30	139	0.60		206-439
102-30	102	0.50		206-402	140-30	140	0.60		206-440
103-30	103	0.50		206-403	141-30	141	0.60		206-441

For more sizes please contact our sales team

All dimensions in mm unless stated otherwise

If a dimension is critical to your application please contact our sales department for confirmation.

Please note : errors and omissions excepted.

When ordering please specify material

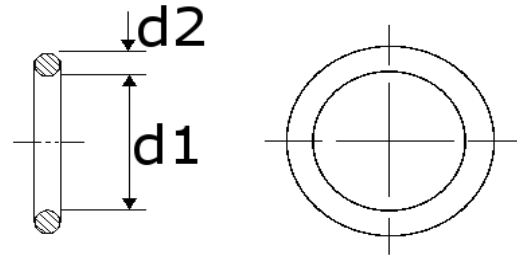

## O-Rings: European (German) Metric Range

Items marked \* are suitable for dynamic applications

APL Code	d1	Tolerance on d1 +/-	d2	Dowty Ref	APL Code	d1	Tolerance on d1 +/-	d2	Dowty Ref
142-30	142	0.60	3.0 +/- 0.10	206-442	180-30	180	0.60	3.0 +/- 0.10	206-480
143-30	143	0.60		206-443	181-30	181	0.80		206-481
144-30	144	0.60		206-444	182-30	182	0.80		206-482
145-30	145	0.60		206-445	183-30	183	0.80		206-483
146-30	146	0.60		206-446	184-30	184	0.80		206-484
147-30	147	0.60		206-447	185-30	185	0.80		206-485
148-30	148	0.60		206-448	186-30	186	0.80		206-486
149-30	149	0.60		206-449	187-30	187	0.80		206-487
150-30	150	0.60		206-450	188-30	188	0.80		206-488
151-30	151	0.60		206-451	189-30	189	0.80		206-489
152-30	152	0.60		206-452	190-30	190	0.80		206-490
153-30	153	0.60		206-453	191-30	191	0.80		206-491
154-30	154	0.60		206-454	192-30	192	0.80		206-492
155-30	155	0.60		206-455	193-30	193	0.80		206-493
156-30	156	0.60		206-456	194-30	194	0.80		206-494
157-30	157	0.60		206-457	195-30	195	0.80		206-495
158-30	158	0.60		206-458	196-30	196	0.80		206-496
159-30	159	0.60		206-459	197-30	197	0.80		206-497
160-30	160	0.60		206-460	198-30	198	0.80		206-498
161-30	161	0.60	206-461	199-30	199	0.80	206-499		
162-30	162	0.60	206-462	200-30	200	0.80	206-500		
163-30	163	0.60	206-463	201-30	201	0.80	206-501		
164-30	164	0.60	206-464	202-30	202	0.80	206-502		
165-30	165	0.60	206-465	203-30	203	0.80	206-503		
166-30	166	0.60	206-466	204-30	204	0.80	206-504		
167-30	167	0.60	206-467	205-30	205	0.80	206-505		
168-30	168	0.60	206-468	206-30	206	0.80	206-506		
169-30	169	0.60	206-469	207-30	207	0.80	206-507		
170-30	170	0.60	206-470	208-30	208	0.80	206-508		
171-30	171	0.60	206-471	209-30	209	0.80	206-509		
172-30	172	0.60	206-472	210-30	210	0.80	206-510		
173-30	173	0.60	206-473	211-30	211	0.80	206-511		
174-30	174	0.60	206-474	212-30	212	0.80	206-512		
175-30	175	0.60	206-475	213-30	213	0.80	206-513		
176-30	176	0.60	206-476	214-30	214	0.80	206-514		
177-30	177	0.60	206-477	215-30	215	0.80	206-515		
178-30	178	0.60	206-478	216-30	216	0.80	206-516		
179-30	179	0.60	206-479	217-30	217	0.80	206-517		

For more sizes please contact our sales team

All dimensions in mm unless stated otherwise

If a dimension is critical to your application please contact our sales department for confirmation.

Please note : errors and omissions excepted.

When ordering please specify material



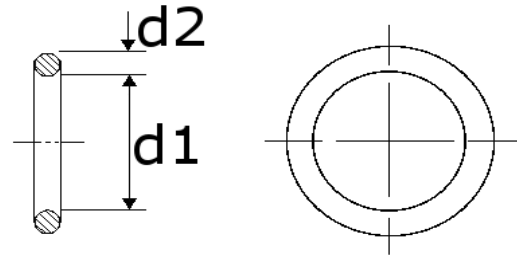

## O-Rings: European (German) Metric Range

Items marked \* are suitable for dynamic applications

APL Code	d1	Tolerance on d1 +/-	d2	Dowty Ref	APL Code	d1	Tolerance on d1 +/-	d2	Dowty Ref
218-30	218	0.80	3.0 +/- 0.10	206-518	013-35*	13	0.20	3.5 +/- 0.10	206-563
219-30	219	0.80		206-519	014-35*	14	0.20		206-564
220-30	220	0.80		206-520	015-35*	15	0.20		206-565
221-30	221	0.80		206-521	016-35*	16	0.20		206-566
222-30	222	0.80		206-522	017-35*	17	0.20		206-567
223-30	223	0.80		206-523	018-35*	18	0.20		206-568
224-30	224	0.80		206-524	019-35*	19	0.25		206-569
225-30	225	0.80		206-525	020-35*	20	0.25		206-570
226-30	226	0.80		206-526	021-35*	21	0.25		206-571
227-30	227	0.80		206-527	022-35*	22	0.25		206-572
228-30	228	0.80		206-528	023-35*	23	0.25		206-573
229-30	229	0.80		206-529	024-35*	24	0.25		206-574
230-30	230	0.80		206-530	025-35*	25	0.25		206-575
231-30	231	0.80		206-531	026-35*	26	0.25		206-576
232-30	232	0.80		206-532	027-35*	27	0.25		206-577
233-30	233	0.80		206-533	028-35*	28	0.25		206-578
234-30	234	0.80		206-534	029-35*	29	0.25		206-579
235-30	235	0.80		206-535	030-35*	30	0.25		206-580
236-30	236	0.80		206-536	031-35*	31	0.30		206-581
237-30	237	0.80		206-537	032-35*	32	0.30		206-582
238-30	238	0.80		206-538	033-35*	33	0.30		206-583
239-30	239	0.80		206-539	034-35*	34	0.30		206-584
240-30	240	0.80		206-540	035-35*	35	0.30		206-585
241-30	241	0.80		206-541	036-35*	36	0.30		206-586
242-30	242	0.80		206-542	037-35*	37	0.30		206-587
243-30	243	0.80		206-543	038-35*	38	0.30		206-588
244-30	244	0.80		206-544	039-35*	39	0.30		206-589
245-30	245	0.80		206-545	040-35*	40	0.30		206-590
246-30	246	0.80		206-546	041-35*	41	0.30		206-591
247-30	247	0.80	206-547	042-35*	42	0.30	206-592		
248-30	248	0.80	206-548	043-35*	43	0.30	206-593		
249-30	249	0.80	206-549	044-35*	44	0.30	206-594		
250-30	250	0.80	206-550	045-35*	45	0.30	206-595		
008-35*	8	0.15	3.5 +/- 0.10	206-558	046-35*	46	0.30	206-596	
009-35*	9	0.15		206-559	047-35*	47	0.30	206-597	
010-35*	10	0.20		206-560	048-35*	48	0.30	206-598	
011-35*	11	0.20		206-561	049-35*	49	0.30	206-599	
012-35*	12	0.20		206-562	050-35*	50	0.30	206-600	

For more sizes please contact our sales team

All dimensions in mm unless stated otherwise

If a dimension is critical to your application please contact our sales department for confirmation.

Please note : errors and omissions excepted.

When ordering please specify material

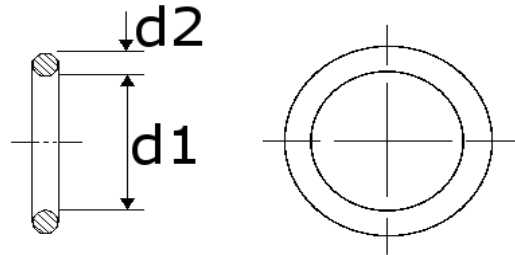

## O-Rings: European (German) Metric Range

Items marked \* are suitable for dynamic applications

APL Code	d1	Tolerance on d1 +/-	d2	Dowty Ref	APL Code	d1	Tolerance on d1 +/-	d2	Dowty Ref
051-35*	51	0.40	3.5 +/- 0.10	206-601	089-35	89	0.50	3.5 +/- 0.10	206-639
052-35*	52	0.40		206-602	090-35	90	0.50		206-640
053-35*	53	0.40		206-603	091-35	91	0.50		206-641
054-35*	54	0.40		206-604	092-35	92	0.50		206-642
055-35*	55	0.40		206-605	093-35	93	0.50		206-643
056-35*	56	0.40		206-606	094-35	94	0.50		206-644
057-35*	57	0.40		206-607	095-35	95	0.50		206-645
058-35*	58	0.40		206-608	096-35	96	0.50		206-646
059-35*	59	0.40		206-609	097-35	97	0.50		206-647
060-35*	60	0.40		206-610	098-35	98	0.50		206-648
061-35	61	0.40		206-611	099-35	99	0.50		206-649
062-35	62	0.40		206-612	100-35	100	0.50		206-650
063-35	63	0.40		206-613	101-35	101	0.50		206-651
064-35	64	0.40		206-614	102-35	102	0.50		206-652
065-35	65	0.40		206-615	103-35	103	0.50		206-653
066-35	66	0.40		206-616	104-35	104	0.50		206-654
067-35	67	0.40		206-617	105-35	105	0.50		206-655
068-35	68	0.40		206-618	106-35	106	0.50		206-656
069-35	69	0.40		206-619	107-35	107	0.50		206-657
070-35	70	0.40		206-620	108-35	108	0.50		206-658
071-35	71	0.40		206-621	109-35	109	0.50		206-659
072-35	72	0.40		206-622	110-35	110	0.50		206-660
073-35	73	0.40		206-623	111-35	111	0.50		206-661
074-35	74	0.40		206-624	112-35	112	0.50		206-662
075-35	75	0.40		206-625	113-35	113	0.50		206-663
076-35	76	0.40		206-626	114-35	114	0.50		206-664
077-35	77	0.40		206-627	115-35	115	0.50		206-665
078-35	78	0.40		206-628	116-35	116	0.50		206-666
079-35	79	0.40		206-629	117-35	117	0.50		206-667
080-35	80	0.40		206-630	118-35	118	0.50		206-668
081-35	81	0.50		206-631	119-35	119	0.50		206-669
082-35	82	0.50		206-632	120-35	120	0.50		206-670
083-35	83	0.50		206-633	121-35	121	0.60		206-671
084-35	84	0.50		206-634	122-35	122	0.60		206-672
085-35	85	0.50		206-635	123-35	123	0.60		206-673
086-35	86	0.50		206-636	124-35	124	0.60		206-674
087-35	87	0.50		206-637	125-35	125	0.60		206-675
088-35	88	0.50		206-638	126-35	126	0.60		206-676

For more sizes please contact our sales team

All dimensions in mm unless stated otherwise

If a dimension is critical to your application please contact our sales department for confirmation.

Please note : errors and omissions excepted.

When ordering please specify material

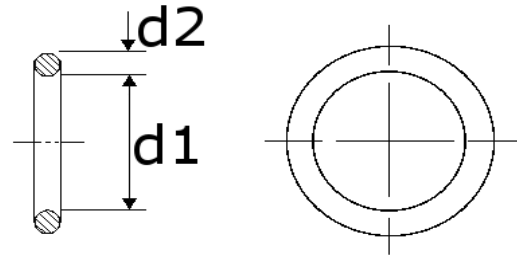

## O-Rings: European (German) Metric Range

Items marked \* are suitable for dynamic applications

APL Code	d1	Tolerance on d1 +/-	d2	Dowty Ref	APL Code	d1	Tolerance on d1 +/-	d2	Dowty Ref
127-35	127	0.60		206-677	165-35	165	0.60		206-715
128-35	128	0.60		206-678	166-35	166	0.60		206-716
129-35	129	0.60		206-679	167-35	167	0.60		206-717
130-35	130	0.60		206-680	168-35	168	0.60		206-718
131-35	131	0.60		206-681	169-35	169	0.60		206-719
132-35	132	0.60		206-682	170-35	170	0.60		206-720
133-35	133	0.60		206-683	171-35	171	0.60		206-721
134-35	134	0.60		206-684	172-35	172	0.60		206-722
135-35	135	0.60		206-685	173-35	173	0.60		206-723
136-35	136	0.60		206-686	174-35	174	0.60		206-724
137-35	137	0.60		206-687	175-35	175	0.60		206-725
138-35	138	0.60		206-688	176-35	176	0.60		206-726
139-35	139	0.60		206-689	177-35	177	0.60		206-727
140-35	140	0.60		206-690	178-35	178	0.60		206-728
141-35	141	0.60		206-691	179-35	179	0.60		206-729
142-35	142	0.60		206-692	180-35	180	0.60		206-730
143-35	143	0.60		206-693	181-35	181	0.80		206-731
144-35	144	0.60		206-694	182-35	182	0.80		206-732
145-35	145	0.60	3.5	206-695	183-35	183	0.80	3.5	206-733
146-35	146	0.60	+/- 0.10	206-696	184-35	184	0.80	+/- 0.10	206-734
147-35	147	0.60		206-697	185-35	185	0.80		206-735
148-35	148	0.60		206-698	186-35	186	0.80		206-736
149-35	149	0.60		206-699	187-35	187	0.80		206-737
150-35	150	0.60		206-700	188-35	188	0.80		206-738
151-35	151	0.60		206-701	189-35	189	0.80		206-739
152-35	152	0.60		206-702	190-35	190	0.80		206-740
153-35	153	0.60		206-703	191-35	191	0.80		206-741
154-35	154	0.60		206-704	192-35	192	0.80		206-742
155-35	155	0.60		206-705	193-35	193	0.80		206-743
156-35	156	0.60		206-706	194-35	194	0.80		206-744
157-35	157	0.60		206-707	195-35	195	0.80		206-745
158-35	158	0.60		206-708	196-35	196	0.80		206-746
159-35	159	0.60		206-709	197-35	197	0.80		206-747
160-35	160	0.60		206-710	198-35	198	0.80		206-748
161-35	161	0.60		206-711	199-35	199	0.80		206-749
162-35	162	0.60		206-712	200-35	200	0.80		206-750
163-35	163	0.60		206-713	201-35	201	0.80		206-751
164-35	164	0.60		206-714	202-35	202	0.80		206-752

For more sizes please contact our sales team

All dimensions in mm unless stated otherwise

If a dimension is critical to your application please contact our sales department for confirmation.

Please note : errors and omissions excepted.

When ordering please specify material

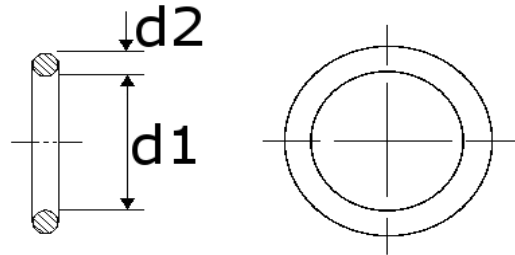

## O-Rings: European (German) Metric Range

Items marked \* are suitable for dynamic applications

APL Code	d1	Tolerance on d1 +/-	d2	Dowty Ref	APL Code	d1	Tolerance on d1 +/-	d2	Dowty Ref
203-35	203	0.80		206-753	241-35	241	0.80		206-791
204-35	204	0.80		206-754	242-35	242	0.80		206-792
205-35	205	0.80		206-755	243-35	243	0.80		206-793
206-35	206	0.80		206-756	244-35	244	0.80		206-794
207-35	207	0.80		206-757	245-35	245	0.80		206-795
208-35	208	0.80		206-758	246-35	246	0.80		206-796
209-35	209	0.80		206-759	247-35	247	0.80		206-797
210-35	210	0.80		206-760	248-35	248	0.80		206-798
211-35	211	0.80		206-761	249-35	249	0.80		206-799
212-35	212	0.80		206-762	250-35	250	0.80		206-800
213-35	213	0.80		206-763	251-35	251	1.00		206-801
214-35	214	0.80		206-764	252-35	252	1.00		206-802
215-35	215	0.80		206-765	253-35	253	1.00		206-803
216-35	216	0.80		206-766	254-35	254	1.00		206-804
217-35	217	0.80		206-767	255-35	255	1.00		206-805
218-35	218	0.80		206-768	256-35	256	1.00		206-806
219-35	219	0.80		206-769	257-35	257	1.00		206-807
220-35	220	0.80		206-770	258-35	258	1.00		206-808
221-35	221	0.80	3.5	206-771	259-35	259	1.00	3.5	206-809
222-35	222	0.80	+/- 0.10	206-772	260-35	260	1.00	+/- 0.10	206-810
223-35	223	0.80		206-773	261-35	261	1.00		206-811
224-35	224	0.80		206-774	262-35	262	1.00		206-812
225-35	225	0.80		206-775	263-35	263	1.00		206-813
226-35	226	0.80		206-776	264-35	264	1.00		206-814
227-35	227	0.80		206-777	265-35	265	1.00		206-815
228-35	228	0.80		206-778	266-35	266	1.00		206-816
229-35	229	0.80		206-779	267-35	267	1.00		206-817
230-35	230	0.80		206-780	268-35	268	1.00		206-818
231-35	231	0.80		206-781	269-35	269	1.00		206-819
232-35	232	0.80		206-782	270-35	270	1.00		206-820
233-35	233	0.80		206-783	271-35	271	1.00		206-821
234-35	234	0.80		206-784	272-35	272	1.00		206-822
235-35	235	0.80		206-785	273-35	273	1.00		206-823
236-35	236	0.80		206-786	274-35	274	1.00		206-824
237-35	237	0.80		206-787	275-35	275	1.00		206-825
238-35	238	0.80		206-788	276-35	276	1.00		206-826
239-35	239	0.80		206-789	277-35	277	1.00		206-827
240-35	240	0.80		206-790	278-35	278	1.00		206-828

For more sizes please contact our sales team

All dimensions in mm unless stated otherwise

If a dimension is critical to your application please contact our sales department for confirmation.

Please note : errors and omissions excepted.

When ordering please specify material

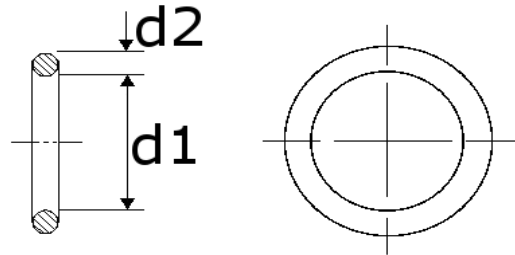

## O-Rings: European (German) Metric Range

Items marked \* are suitable for dynamic applications

APL Code	d1	Tolerance on d1 +/-	d2	Dowty Ref	APL Code	d1	Tolerance on d1 +/-	d2	Dowty Ref
279-35	279	1.00		206-829	317-35	317	1.50		206-867
280-35	280	1.00		206-830	318-35	318	1.50		206-868
281-35	281	1.00		206-831	319-35	319	1.50		206-869
282-35	282	1.00		206-832	320-35	320	1.50		206-870
283-35	283	1.00		206-833	321-35	321	1.50		206-871
284-35	284	1.00		206-834	322-35	322	1.50		206-872
285-35	285	1.00		206-835	323-35	323	1.50		206-873
286-35	286	1.00		206-836	324-35	324	1.50		206-874
287-35	287	1.00		206-837	325-35	325	1.50		206-875
288-35	288	1.00		206-838	326-35	326	1.50		206-876
289-35	289	1.00		206-839	327-35	327	1.50		206-877
290-35	290	1.00		206-840	328-35	328	1.50		206-878
291-35	291	1.00		206-841	329-35	329	1.50		206-879
292-35	292	1.00		206-842	330-35	330	1.50		206-880
293-35	293	1.00		206-843	331-35	331	1.50		206-881
294-35	294	1.00		206-844	332-35	332	1.50		206-882
295-35	295	1.00		206-845	333-35	333	1.50		206-883
296-35	296	1.00		206-846	334-35	334	1.50		206-884
297-35	297	1.00	3.5	206-847	335-35	335	1.50	3.5	206-885
298-35	298	1.00	+/- 0.10	206-848	336-35	336	1.50	+/- 0.10	206-886
299-35	299	1.00		206-849	337-35	337	1.50		206-887
300-35	300	1.50		206-850	338-35	338	1.50		206-888
301-35	301	1.50		206-851	339-35	339	1.50		206-889
302-35	302	1.50		206-852	340-35	340	1.50		206-890
303-35	303	1.50		206-853	341-35	341	1.50		206-891
304-35	304	1.50		206-854	342-35	342	1.50		206-892
305-35	305	1.50		206-855	343-35	343	1.50		206-893
306-35	306	1.50		206-856	344-35	344	1.50		206-894
307-35	307	1.50		206-857	345-35	345	1.50		206-895
308-35	308	1.50		206-858	346-35	346	1.50		206-896
309-35	309	1.50		206-859	347-35	347	1.50		206-897
310-35	310	1.50		206-860	348-35	348	1.50		206-898
311-35	311	1.50		206-861	349-35	349	1.50		206-899
312-35	312	1.50		206-862	350-35	350	1.50		206-900
313-35	313	1.50		206-863	351-35	351	1.50		206-901
314-35	314	1.50		206-864	352-35	352	1.50		206-902
315-35	315	1.50		206-865	353-35	353	1.50		206-903
316-35	316	1.50		206-866	354-35	354	1.50		206-904

For more sizes please contact our sales team

All dimensions in mm unless stated otherwise

If a dimension is critical to your application please contact our sales department for confirmation.

Please note : errors and omissions excepted.

When ordering please specify material

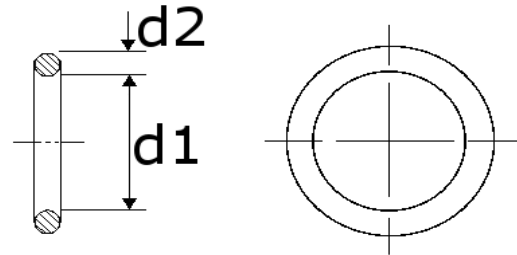

## O-Rings: European (German) Metric Range

Items marked \* are suitable for dynamic applications

APL Code	d1	Tolerance on d1 +/-	d2	Dowty Ref	APL Code	d1	Tolerance on d1 +/-	d2	Dowty Ref
355-35	355	1.50		206-905	393-35	393	1.50		206-943
356-35	356	1.50		206-906	394-35	394	1.50		206-944
357-35	357	1.50		206-907	395-35	395	1.50		206-945
358-35	358	1.50		206-908	396-35	396	1.50		206-946
359-35	359	1.50		206-909	397-35	397	1.50		206-947
360-35	360	1.50		206-910	398-35	398	1.50		206-948
361-35	361	1.50		206-911	399-35	399	1.50		206-949
362-35	362	1.50		206-912	400-35	400	1.50		206-950
363-35	363	1.50		206-913	401-35	401	2.00		206-951
364-35	364	1.50		206-914	402-35	402	2.00		206-952
365-35	365	1.50		206-915	403-35	403	2.00		206-953
366-35	366	1.50		206-916	404-35	404	2.00		206-954
367-35	367	1.50		206-917	405-35	405	2.00		206-955
368-35	368	1.50		206-918	406-35	406	2.00		206-956
369-35	369	1.50		206-919	407-35	407	2.00		206-957
370-35	370	1.50		206-920	408-35	408	2.00		206-958
371-35	371	1.50		206-921	409-35	409	2.00		206-959
372-35	372	1.50		206-922	410-35	410	2.00		206-960
373-35	373	1.50	3.5	206-923	411-35	411	2.00	3.5	206-961
374-35	374	1.50	+/- 0.10	206-924	412-35	412	2.00	+/- 0.10	206-962
375-35	375	1.50		206-925	413-35	413	2.00		206-963
376-35	376	1.50		206-926	414-35	414	2.00		206-964
377-35	377	1.50		206-927	415-35	415	2.00		206-965
378-35	378	1.50		206-928	416-35	416	2.00		206-966
379-35	379	1.50		206-929	417-35	417	2.00		206-967
380-35	380	1.50		206-930	418-35	418	2.00		206-968
381-35	381	1.50		206-931	419-35	419	2.00		206-969
382-35	382	1.50		206-932	420-35	420	2.00		206-970
383-35	383	1.50		206-933	421-35	421	2.00		206-971
384-35	384	1.50		206-934	422-35	422	2.00		206-972
385-35	385	1.50		206-935	423-35	423	2.00		206-973
386-35	386	1.50		206-936	424-35	424	2.00		206-974
387-35	387	1.50		206-937	425-35	425	2.00		206-975
388-35	388	1.50		206-938	426-35	426	2.00		206-976
389-35	389	1.50		206-939	427-35	427	2.00		206-977
390-35	390	1.50		206-940	428-35	428	2.00		206-978
391-35	391	1.50		206-941	429-35	429	2.00		206-979
392-35	392	1.50		206-942	430-35	430	2.00		206-980

For more sizes please contact our sales team

All dimensions in mm unless stated otherwise

If a dimension is critical to your application please contact our sales department for confirmation.

Please note : errors and omissions excepted.

When ordering please specify material

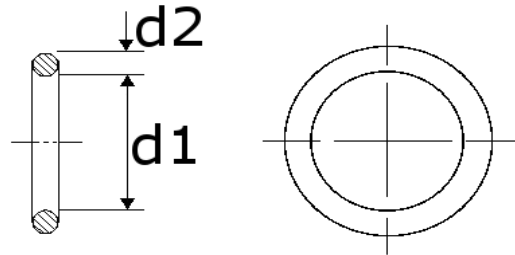

## O-Rings: European (German) Metric Range

Items marked \* are suitable for dynamic applications

APL Code	d1	Tolerance on d1 +/-	d2	Dowty Ref	APL Code	d1	Tolerance on d1 +/-	d2	Dowty Ref
431-35	431	2.00	3.5 +/- 0.10	206-981	032-40*	32	0.30	4.0 +/- 0.12	204-132
432-35	432	2.00		206-982	033-40*	33	0.30		204-133
433-35	433	2.00		206-983	034-40*	34	0.30		204-134
434-35	434	2.00		206-984	035-40*	35	0.30		204-135
435-35	435	2.00		206-985	036-40*	36	0.30		204-136
436-35	436	2.00		206-986	037-40*	37	0.30		204-137
437-35	437	2.00		206-987	038-40*	38	0.30		204-138
438-35	438	2.00		206-988	039-40*	39	0.30		204-139
439-35	439	2.00		206-989	040-40*	40	0.30		204-140
440-35	440	2.00		206-990	041-40*	41	0.30		204-141
004-40*	4	0.15	4 +/- 0.12	204-104	042-40*	42	0.30	204-142	
005-40*	5	0.15		204-105	043-40*	43	0.30	204-143	
006-40*	6	0.15		204-106	044-40*	44	0.30	204-144	
007-40*	7	0.15		204-107	045-40*	45	0.30	204-145	
008-40*	8	0.15		204-108	046-40*	46	0.30	204-146	
009-40*	9	0.15		204-109	047-40*	47	0.30	204-147	
010-40*	10	0.20		204-110	048-40*	48	0.30	204-148	
011-40*	11	0.20		204-111	049-40*	49	0.30	204-149	
012-40*	12	0.20		204-112	050-40*	50	0.30	204-150	
013-40*	13	0.20		204-113	051-40*	51	0.40	204-151	
014-40*	14	0.20		204-114	052-40*	52	0.40	204-152	
015-40*	15	0.20		204-115	053-40*	53	0.40	204-153	
016-40*	16	0.20		204-116	054-40*	54	0.40	204-154	
017-40*	17	0.20		204-117	055-40*	55	0.40	204-155	
018-40*	18	0.20		204-118	056-40*	56	0.40	204-156	
019-40*	19	0.25		204-119	057-40*	57	0.40	204-157	
020-40*	20	0.25		204-120	058-40*	58	0.40	204-158	
021-40*	21	0.25		204-121	059-40*	59	0.40	204-159	
022-40*	22	0.25		204-122	060-40*	60	0.40	204-160	
023-40*	23	0.25		204-123	061-40*	61	0.40	204-161	
024-40*	24	0.25	204-124	062-40*	62	0.40	204-162		
025-40*	25	0.25	204-125	063-40*	63	0.40	204-163		
026-40*	26	0.25	204-126	064-40*	64	0.40	204-164		
027-40*	27	0.25	204-127	065-40*	65	0.40	204-165		
028-40*	28	0.25	204-128	066-40*	66	0.40	204-166		
029-40*	29	0.25	204-129	067-40*	67	0.40	204-167		
030-40*	30	0.25	204-130	068-40*	68	0.40	204-168		
031-40*	31	0.30	204-131	069-40*	69	0.40	204-169		

For more sizes please contact our sales team

All dimensions in mm unless stated otherwise

If a dimension is critical to your application please contact our sales department for confirmation.

Please note : errors and omissions excepted.

When ordering please specify material

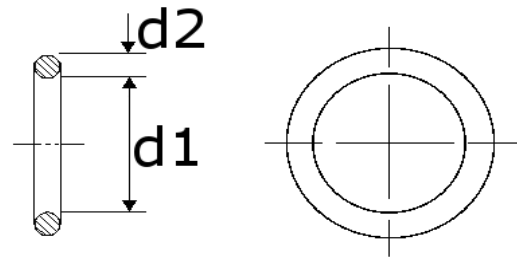

## O-Rings: European (German) Metric Range

Items marked \* are suitable for dynamic applications

APL Code	d1	Tolerance on d1 +/-	d2	Dowty Ref	APL Code	d1	Tolerance on d1 +/-	d2	Dowty Ref
070-40*	70	0.40	4.0 +/- 0.12	204-170	108-40	108	0.50	4.0 +/- 0.12	204-208
071-40*	71	0.40		204-171	109-40	109	0.50		204-209
072-40*	72	0.40		204-172	110-40	110	0.50		204-210
073-40*	73	0.40		204-173	111-40	111	0.50		204-211
074-40*	74	0.40		204-174	112-40	112	0.50		204-212
075-40*	75	0.40		204-175	113-40	113	0.50		204-213
076-40*	76	0.40		204-176	114-40	114	0.50		204-214
077-40*	77	0.40		204-177	115-40	115	0.50		204-215
078-40*	78	0.40		204-178	116-40	116	0.50		204-216
079-40*	79	0.40		204-179	117-40	117	0.50		204-217
080-40*	80	0.40		204-180	118-40	118	0.50		204-218
081-40	81	0.50		204-181	119-40	119	0.50		204-219
082-40	82	0.50		204-182	120-40	120	0.50		204-220
083-40	83	0.50		204-183	121-40	121	0.60		204-221
084-40	84	0.50		204-184	122-40	122	0.60		204-222
085-40	85	0.50		204-185	123-40	123	0.60		204-223
086-40	86	0.50		204-186	124-40	124	0.60		204-224
087-40	87	0.50		204-187	125-40	125	0.60		204-225
088-40	88	0.50		204-188	126-40	126	0.60		204-226
089-40	89	0.50		204-189	127-40	127	0.60		204-227
090-40	90	0.50		204-190	128-40	128	0.60		204-228
091-40	91	0.50		204-191	129-40	129	0.60		204-229
092-40	92	0.50		204-192	130-40	130	0.60		204-230
093-40	93	0.50		204-193	131-40	131	0.60		204-231
094-40	94	0.50		204-194	132-40	132	0.60		204-232
095-40	95	0.50		204-195	133-40	133	0.60		204-233
096-40	96	0.50		204-196	134-40	134	0.60		204-234
097-40	97	0.50		204-197	135-40	135	0.60		204-235
098-40	98	0.50		204-198	136-40	136	0.60		204-236
099-40	99	0.50		204-199	137-40	137	0.60		204-237
100-40	100	0.50		204-200	138-40	138	0.60		204-238
101-40	101	0.50		204-201	139-40	139	0.60		204-239
102-40	102	0.50		204-202	140-40	140	0.60		204-240
103-40	103	0.50		204-203	141-40	141	0.60		204-241
104-40	104	0.50		204-204	142-40	142	0.60		204-242
105-40	105	0.50		204-205	143-40	143	0.60		204-243
106-40	106	0.50		204-206	144-40	144	0.60		204-244
107-40	107	0.50		204-207	145-40	145	0.60		204-245

For more sizes please contact our sales team

All dimensions in mm unless stated otherwise

If a dimension is critical to your application please contact our sales department for confirmation.

Please note : errors and omissions excepted.

When ordering please specify material



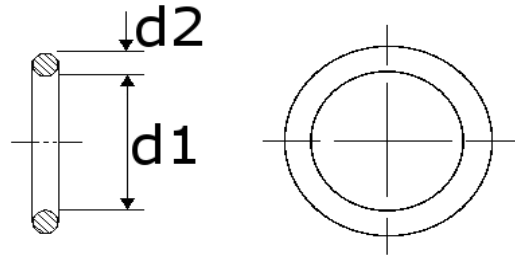

## O-Rings: European (German) Metric Range

Items marked \* are suitable for dynamic applications

APL Code	d1	Tolerance on d1 +/-	d2	Dowty Ref	APL Code	d1	Tolerance on d1 +/-	d2	Dowty Ref
146-40	146	0.60		204-246	184-40	184	0.80		204-284
147-40	147	0.60		204-247	185-40	185	0.80		204-285
148-40	148	0.60		204-248	186-40	186	0.80		204-286
149-40	149	0.60		204-249	187-40	187	0.80		204-287
150-40	150	0.60		204-250	188-40	188	0.80		204-288
151-40	151	0.60		204-251	189-40	189	0.80		204-289
152-40	152	0.60		204-252	190-40	190	0.80		204-290
153-40	153	0.60		204-253	191-40	191	0.80		204-291
154-40	154	0.60		204-254	192-40	192	0.80		204-292
155-40	155	0.60		204-255	193-40	193	0.80		204-293
156-40	156	0.60		204-256	194-40	194	0.80		204-294
157-40	157	0.60		204-257	195-40	195	0.80		204-295
158-40	158	0.60		204-258	196-40	196	0.80		204-296
159-40	159	0.60		204-259	197-40	197	0.80		204-297
160-40	160	0.60		204-260	198-40	198	0.80		204-298
161-40	161	0.60		204-261	199-40	199	0.80		204-299
162-40	162	0.60		204-262	200-40	200	0.80		204-300
163-40	163	0.60		204-263	201-40	201	0.80		204-301
164-40	164	0.60	4.0	204-264	202-40	202	0.80	4.0	204-302
165-40	165	0.60	+/- 0.12	204-265	203-40	203	0.80	+/- 0.12	204-303
166-40	166	0.60		204-266	204-40	204	0.80		204-304
167-40	167	0.60		204-267	205-40	205	0.80		204-305
168-40	168	0.60		204-268	206-40	206	0.80		204-306
169-40	169	0.60		204-269	207-40	207	0.80		204-307
170-40	170	0.60		204-270	208-40	208	0.80		204-308
171-40	171	0.60		204-271	209-40	209	0.80		204-309
172-40	172	0.60		204-272	210-40	210	0.80		204-310
173-40	173	0.60		204-273	211-40	211	0.80		204-311
174-40	174	0.60		204-274	212-40	212	0.80		204-312
175-40	175	0.60		204-275	213-40	213	0.80		204-313
176-40	176	0.60		204-276	214-40	214	0.80		204-314
177-40	177	0.60		204-277	215-40	215	0.80		204-315
178-40	178	0.60		204-278	216-40	216	0.80		204-316
179-40	179	0.60		204-279	217-40	217	0.80		204-317
180-40	180	0.60		204-280	218-40	218	0.80		204-318
181-40	181	0.80		204-281	219-40	219	0.80		204-319
182-40	182	0.80		204-282	220-40	220	0.80		204-320
183-40	183	0.80		204-283	221-40	221	0.80		204-321

For more sizes please contact our sales team

All dimensions in mm unless stated otherwise

If a dimension is critical to your application please contact our sales department for confirmation.

Please note : errors and omissions excepted.

When ordering please specify material

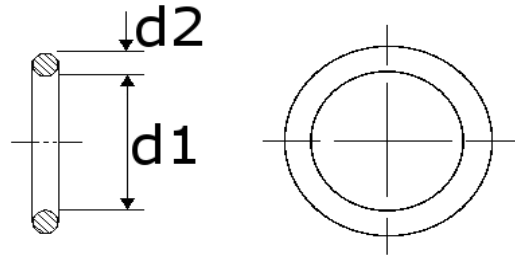

## O-Rings: European (German) Metric Range

Items marked \* are suitable for dynamic applications

APL Code	d1	Tolerance on d1 +/-	d2	Dowty Ref	APL Code	d1	Tolerance on d1 +/-	d2	Dowty Ref
222-40	222	0.80	4.0 +/- 0.12	204-322	260-40	260	1.00	4.0 +/- 0.12	204-360
223-40	223	0.80		204-323	261-40	261	1.00		204-361
224-40	224	0.80		204-324	262-40	262	1.00		204-362
225-40	225	0.80		204-325	263-40	263	1.00		204-363
226-40	226	0.80		204-326	264-40	264	1.00		204-364
227-40	227	0.80		204-327	265-40	265	1.00		204-365
228-40	228	0.80		204-328	266-40	266	1.00		204-366
229-40	229	0.80		204-329	267-40	267	1.00		204-367
230-40	230	0.80		204-330	268-40	268	1.00		204-368
231-40	231	0.80		204-331	269-40	269	1.00		204-369
232-40	232	0.80		204-332	270-40	270	1.00		204-370
233-40	233	0.80		204-333	271-40	271	1.00		204-371
234-40	234	0.80		204-334	272-40	272	1.00		204-372
235-40	235	0.80		204-335	273-40	273	1.00		204-373
236-40	236	0.80		204-336	274-40	274	1.00		204-374
237-40	237	0.80		204-337	275-40	275	1.00		204-375
238-40	238	0.80		204-338	276-40	276	1.00		204-376
239-40	239	0.80		204-339	277-40	277	1.00		204-377
240-40	240	0.80		204-340	278-40	278	1.00		204-378
241-40	241	0.80		204-341	279-40	279	1.00		204-379
242-40	242	0.80		204-342	280-40	280	1.00		204-380
243-40	243	0.80		204-343	281-40	281	1.00		204-381
244-40	244	0.80		204-344	282-40	282	1.00		204-382
245-40	245	0.80		204-345	283-40	283	1.00		204-383
246-40	246	0.80		204-346	284-40	284	1.00		204-384
247-40	247	0.80		204-347	285-40	285	1.00		204-385
248-40	248	0.80		204-348	286-40	286	1.00		204-386
249-40	249	0.80		204-349	287-40	287	1.00		204-387
250-40	250	0.80		204-350	288-40	288	1.00		204-388
251-40	251	1.00	204-351	289-40	289	1.00	204-389		
252-40	252	1.00	204-352	290-40	290	1.00	204-390		
253-40	253	1.00	204-353	291-40	291	1.00	204-391		
254-40	254	1.00	204-354	292-40	292	1.00	204-392		
255-40	255	1.00	204-355	293-40	293	1.00	204-393		
256-40	256	1.00	204-356	294-40	294	1.00	204-394		
257-40	257	1.00	204-357	295-40	295	1.00	204-395		
258-40	258	1.00	204-358	296-40	296	1.00	204-396		
259-40	259	1.00	204-359	297-40	297	1.00	204-397		

For more sizes please contact our sales team

All dimensions in mm unless stated otherwise

If a dimension is critical to your application please contact our sales department for confirmation.

Please note : errors and omissions excepted.

When ordering please specify material

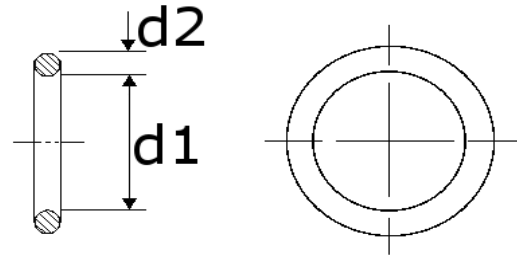

## O-Rings: European (German) Metric Range

Items marked \* are suitable for dynamic applications

APL Code	d1	Tolerance on d1 +/-	d2	Dowty Ref	APL Code	d1	Tolerance on d1 +/-	d2	Dowty Ref
298-40	298	1.00	4.0 +/- 0.12	204-398	336-40	336	1.50	4.0 +/- 0.12	204-436
299-40	299	1.00		204-399	337-40	337	1.50		204-437
300-40	300	1.00		204-400	338-40	338	1.50		204-438
301-40	301	1.50		204-401	339-40	339	1.50		204-439
302-40	302	1.50		204-402	340-40	340	1.50		204-440
303-40	303	1.50		204-403	341-40	341	1.50		204-441
304-40	304	1.50		204-404	342-40	342	1.50		204-442
305-40	305	1.50		204-405	343-40	343	1.50		204-443
306-40	306	1.50		204-406	344-40	344	1.50		204-444
307-40	307	1.50		204-407	345-40	345	1.50		204-445
308-40	308	1.50		204-408	346-40	346	1.50		204-446
309-40	309	1.50		204-409	347-40	347	1.50		204-447
310-40	310	1.50		204-410	348-40	348	1.50		204-448
311-40	311	1.50		204-411	349-40	349	1.50		204-449
312-40	312	1.50		204-412	350-40	350	1.50		204-450
313-40	313	1.50		204-413	351-40	351	1.50		204-451
314-40	314	1.50		204-414	352-40	352	1.50		204-452
315-40	315	1.50		204-415	353-40	353	1.50		204-453
316-40	316	1.50		204-416	354-40	354	1.50		204-454
317-40	317	1.50		204-417	355-40	355	1.50		204-455
318-40	318	1.50		204-418	356-40	356	1.50		204-456
319-40	319	1.50		204-419	357-40	357	1.50		204-457
320-40	320	1.50		204-420	358-40	358	1.50		204-458
321-40	321	1.50		204-421	359-40	359	1.50		204-459
322-40	322	1.50		204-422	360-40	360	1.50		204-460
323-40	323	1.50		204-423	361-40	361	1.50		204-461
324-40	324	1.50		204-424	362-40	362	1.50		204-462
325-40	325	1.50		204-425	363-40	363	1.50		204-463
326-40	326	1.50		204-426	364-40	364	1.50		204-464
327-40	327	1.50		204-427	365-40	365	1.50		204-465
328-40	328	1.50		204-428	366-40	366	1.50		204-466
329-40	329	1.50		204-429	367-40	367	1.50		204-467
330-40	330	1.50		204-430	368-40	368	1.50		204-468
331-40	331	1.50		204-431	369-40	369	1.50		204-469
332-40	332	1.50		204-432	370-40	370	1.50		204-470
333-40	333	1.50	204-433	371-40	371	1.50	204-471		
334-40	334	1.50	204-434	372-40	372	1.50	204-472		
335-40	335	1.50	204-435	373-40	373	1.50	204-473		

For more sizes please contact our sales team

All dimensions in mm unless stated otherwise

If a dimension is critical to your application please contact our sales department for confirmation.

Please note : errors and omissions excepted.

When ordering please specify material

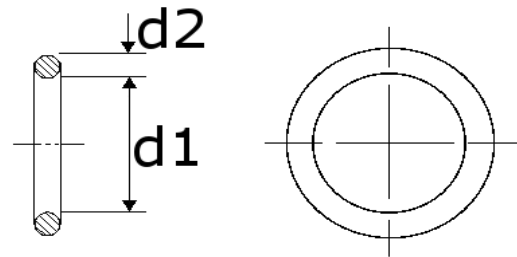

## O-Rings: European (German) Metric Range

Items marked \* are suitable for dynamic applications

APL Code	d1	Tolerance on d1 +/-	d2	Dowty Ref	APL Code	d1	Tolerance on d1 +/-	d2	Dowty Ref
374-40	374	1.50	4.0 +/- 0.12	204-474	412-40	412	2.00	4.0 +/- 0.12	204-512
375-40	375	1.50		204-475	413-40	413	2.00		204-513
376-40	376	1.50		204-476	414-40	414	2.00		204-514
377-40	377	1.50		204-477	415-40	415	2.00		204-515
378-40	378	1.50		204-478	416-40	416	2.00		204-516
379-40	379	1.50		204-479	417-40	417	2.00		204-517
380-40	380	1.50		204-480	418-40	418	2.00		204-518
381-40	381	1.50		204-481	419-40	419	2.00		204-519
382-40	382	1.50		204-482	420-40	420	2.00		204-520
383-40	383	1.50		204-483	421-40	421	2.00		204-521
384-40	384	1.50		204-484	422-40	422	2.00		204-522
385-40	385	1.50		204-485	423-40	423	2.00		204-523
386-40	386	1.50		204-486	424-40	424	2.00		204-524
387-40	387	1.50		204-487	425-40	425	2.00		204-525
388-40	388	1.50		204-488	426-40	426	2.00		204-526
389-40	389	1.50		204-489	427-40	427	2.00		204-527
390-40	390	1.50		204-490	428-40	428	2.00		204-528
391-40	391	1.50		204-491	429-40	429	2.00		204-529
392-40	392	1.50		204-492	430-40	430	2.00		204-530
393-40	393	1.50		204-493	431-40	431	2.00		204-531
394-40	394	1.50		204-494	432-40	432	2.00		204-532
395-40	395	1.50		204-495	433-40	433	2.00		204-533
396-40	396	1.50		204-496	434-40	434	2.00		204-534
397-40	397	1.50		204-497	435-40	435	2.00		204-535
398-40	398	1.50		204-498	436-40	436	2.00		204-536
399-40	399	1.50		204-499	437-40	437	2.00		204-537
400-40	400	1.50		204-500	438-40	438	2.00		204-538
401-40	401	2.00		204-501	439-40	439	2.00		204-539
402-40	402	2.00		204-502	440-40	440	2.00		204-540
403-40	403	2.00		204-503	441-40	441	2.00		204-541
404-40	404	2.00		204-504	442-40	442	2.00		204-542
405-40	405	2.00		204-505	443-40	443	2.00		204-543
406-40	406	2.00		204-506	444-40	444	2.00		204-544
407-40	407	2.00		204-507	445-40	445	2.00		204-545
408-40	408	2.00		204-508	446-40	446	2.00		204-546
409-40	409	2.00		204-509	447-40	447	2.00		204-547
410-40	410	2.00		204-510	448-40	448	2.00		204-548
411-40	411	2.00		204-511	449-40	449	2.00		204-549

For more sizes please contact our sales team

All dimensions in mm unless stated otherwise

If a dimension is critical to your application please contact our sales department for confirmation.

Please note : errors and omissions excepted.

When ordering please specify material

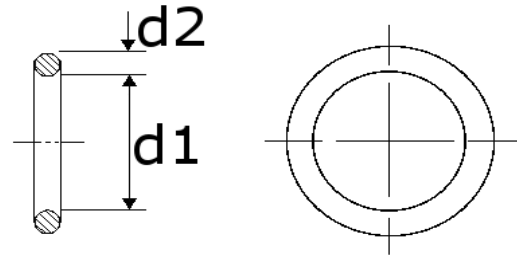

## O-Rings: European (German) Metric Range

Items marked \* are suitable for dynamic applications

APL Code	d1	Tolerance on d1 +/-	d2	Dowty Ref	APL Code	d1	Tolerance on d1 +/-	d2	Dowty Ref	
450-40	450	2.00	4.0 +/- 0.12	204-550	488-40	488	2.00	4.0 +/- 0.12	204-588	
451-40	451	2.00		204-551	489-40	489	2.00		204-589	
452-40	452	2.00		204-552	490-40	490	2.00		204-590	
453-40	453	2.00		204-553	491-40	491	2.00		204-591	
454-40	454	2.00		204-554	492-40	492	2.00		204-592	
455-40	455	2.00		204-555	493-40	493	2.00		204-593	
456-40	456	2.00		204-556	494-40	494	2.00		204-594	
457-40	457	2.00		204-557	495-40	495	2.00		204-595	
458-40	458	2.00		204-558	496-40	496	2.00		204-596	
459-40	459	2.00		204-559	497-40	497	2.00		204-597	
460-40	460	2.00		204-560	498-40	498	2.00		204-598	
461-40	461	2.00		204-561	499-40	499	2.00		204-599	
462-40	462	2.00		204-562	500-40	500	2.00		204-600	
463-40	463	2.00		204-563	004-50*	4	0.15		5.0 +/- 0.12	204-604
464-40	464	2.00		204-564	005-50*	5	0.15			204-605
465-40	465	2.00		204-565	006-50*	6	0.15			204-606
466-40	466	2.00		204-566	007-50*	7	0.15			204-607
467-40	467	2.00		204-567	008-50*	8	0.15			204-608
468-40	468	2.00		204-568	009-50*	9	0.15			204-609
469-40	469	2.00		204-569	010-50*	10	0.15	204-610		
470-40	470	2.00		204-570	011-50*	11	0.20	204-611		
471-40	471	2.00		204-571	012-50*	12	0.20	204-612		
472-40	472	2.00		204-572	013-50*	13	0.20	204-613		
473-40	473	2.00		204-573	014-50*	14	0.20	204-614		
474-40	474	2.00		204-574	015-50*	15	0.20	204-615		
475-40	475	2.00		204-575	016-50*	16	0.20	204-616		
476-40	476	2.00		204-576	017-50*	17	0.20	204-617		
477-40	477	2.00		204-577	018-50*	18	0.20	204-618		
478-40	478	2.00		204-578	019-50*	19	0.25	204-619		
479-40	479	2.00		204-579	020-50*	20	0.25	204-620		
480-40	480	2.00		204-580	021-50*	21	0.25	204-621		
481-40	481	2.00		204-581	022-50*	22	0.25	204-622		
482-40	482	2.00		204-582	023-50*	23	0.25	204-623		
483-40	483	2.00		204-583	024-50*	24	0.25	204-624		
484-40	484	2.00		204-584	025-50*	25	0.25	204-625		
485-40	485	2.00		204-585	026-50*	26	0.25	204-626		
486-40	486	2.00		204-586	027-50*	27	0.25	204-627		
487-40	487	2.00		204-587	028-50*	28	0.25	204-628		

For more sizes please contact our sales team

All dimensions in mm unless stated otherwise

If a dimension is critical to your application please contact our sales department for confirmation.

Please note : errors and omissions excepted.

When ordering please specify material

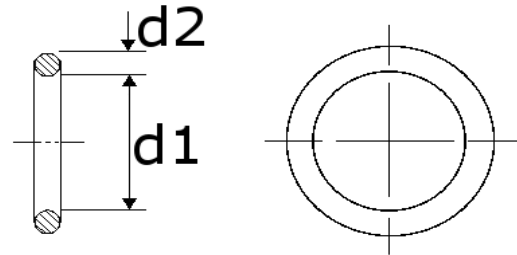

## O-Rings: European (German) Metric Range

Items marked \* are suitable for dynamic applications

APL Code	d1	Tolerance on d1 +/-	d2	Dowty Ref	APL Code	d1	Tolerance on d1 +/-	d2	Dowty Ref
029-50*	29	0.25	5.0 +/- 0.12	204-629	067-50*	67	0.40	5.0 +/- 0.12	204-667
030-50*	30	0.25		204-630	068-50*	68	0.40		204-668
031-50*	31	0.30		204-631	069-50*	69	0.40		204-669
032-50*	32	0.30		204-632	070-50*	70	0.40		204-670
033-50*	33	0.30		204-633	071-50*	71	0.40		204-671
034-50*	34	0.30		204-634	072-50*	72	0.40		204-672
035-50*	35	0.30		204-635	073-50*	73	0.40		204-673
036-50*	36	0.30		204-636	074-50*	74	0.40		204-674
037-50*	37	0.30		204-637	075-50*	75	0.40		204-675
038-50*	38	0.30		204-638	076-50*	76	0.40		204-676
039-50*	39	0.30		204-639	077-50*	77	0.40		204-677
040-50*	40	0.30		204-640	078-50*	78	0.40		204-678
041-50*	41	0.30		204-641	079-50*	79	0.40		204-679
042-50*	42	0.30		204-642	080-50*	80	0.40		204-680
043-50*	43	0.30		204-643	081-50*	81	0.50		204-681
044-50*	44	0.30		204-644	082-50*	82	0.50		204-682
045-50*	45	0.30		204-645	083-50*	83	0.50		204-683
046-50*	46	0.30		204-646	084-50*	84	0.50		204-684
047-50*	47	0.30		204-647	085-50*	85	0.50		204-685
048-50*	48	0.30		204-648	086-50*	86	0.50		204-686
049-50*	49	0.30		204-649	087-50*	87	0.50		204-687
050-50*	50	0.30		204-650	088-50*	88	0.50		204-688
051-50*	51	0.40		204-651	089-50*	89	0.50		204-689
052-50*	52	0.40		204-652	090-50*	90	0.50		204-690
053-50*	53	0.40		204-653	091-50*	91	0.50		204-691
054-50*	54	0.40		204-654	092-50*	92	0.50		204-692
055-50*	55	0.40		204-655	093-50*	93	0.50		204-693
056-50*	56	0.40		204-656	094-50*	94	0.50		204-694
057-50*	57	0.40		204-657	095-50*	95	0.50		204-695
058-50*	58	0.40		204-658	096-50*	96	0.50		204-696
059-50*	59	0.40		204-659	097-50*	97	0.50		204-697
060-50*	60	0.40		204-660	098-50*	98	0.50		204-698
061-50*	61	0.40		204-661	099-50*	99	0.50		204-699
062-50*	62	0.40		204-662	100-50*	100	0.50		204-700
063-50*	63	0.40		204-663	101-50*	101	0.50		204-701
064-50*	64	0.40		204-664	102-50*	102	0.50		204-702
065-50*	65	0.40		204-665	103-50*	103	0.50		204-703
066-50*	66	0.40		204-666	104-50*	104	0.50		204-704

For more sizes please contact our sales team

All dimensions in mm unless stated otherwise

If a dimension is critical to your application please contact our sales department for confirmation.

Please note : errors and omissions excepted.

When ordering please specify material

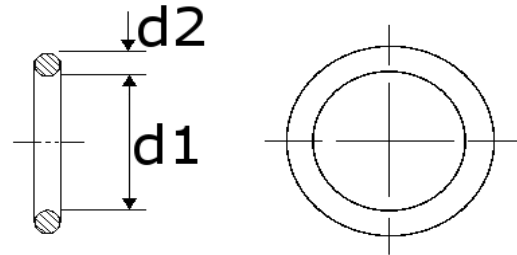

## O-Rings: European (German) Metric Range

Items marked \* are suitable for dynamic applications

APL Code	d1	Tolerance on d1 +/-	d2	Dowty Ref	APL Code	d1	Tolerance on d1 +/-	d2	Dowty Ref
105-50*	105	0.50		204-705	143-50	143	0.60		204-743
106-50*	106	0.50		204-706	144-50	144	0.60		204-744
107-50*	107	0.50		204-707	145-50	145	0.60		204-745
108-50*	108	0.50		204-708	146-50	146	0.60		204-746
109-50*	109	0.50		204-709	147-50	147	0.60		204-747
110-50*	110	0.50		204-710	148-50	148	0.60		204-748
111-50*	111	0.50		204-711	149-50	149	0.60		204-749
112-50*	112	0.50		204-712	150-50	150	0.60		204-750
113-50*	113	0.50		204-713	151-50	151	0.60		204-751
114-50*	114	0.50		204-714	152-50	152	0.60		204-752
115-50*	115	0.50		204-715	153-50	153	0.60		204-753
116-50*	116	0.50		204-716	154-50	154	0.60		204-754
117-50*	117	0.50		204-717	155-50	155	0.60		204-755
118-50*	118	0.50		204-718	156-50	156	0.60		204-756
119-50*	119	0.50		204-719	157-50	157	0.60		204-757
120-50*	120	0.50		204-720	158-50	158	0.60		204-758
121-50	121	0.60		204-721	159-50	159	0.60		204-759
122-50	122	0.60		204-722	160-50	160	0.60		204-760
123-50	123	0.60	5.0	204-723	161-50	161	0.60	5.0	204-761
124-50	124	0.60	+/- 0.12	204-724	162-50	162	0.60	+/- 0.12	204-762
125-50	125	0.60		204-725	163-50	163	0.60		204-763
126-50	126	0.60		204-726	164-50	164	0.60		204-764
127-50	127	0.60		204-727	165-50	165	0.60		204-765
128-50	128	0.60		204-728	166-50	166	0.60		204-766
129-50	129	0.60		204-729	167-50	167	0.60		204-767
130-50	130	0.60		204-730	168-50	168	0.60		204-768
131-50	131	0.60		204-731	169-50	169	0.60		204-769
132-50	132	0.60		204-732	170-50	170	0.60		204-770
133-50	133	0.60		204-733	171-50	171	0.60		204-771
134-50	134	0.60		204-734	172-50	172	0.60		204-772
135-50	135	0.60		204-735	173-50	173	0.60		204-773
136-50	136	0.60		204-736	174-50	174	0.60		204-774
137-50	137	0.60		204-737	175-50	175	0.60		204-775
138-50	138	0.60		204-738	176-50	176	0.60		204-776
139-50	139	0.60		204-739	177-50	177	0.60		204-777
140-50	140	0.60		204-740	178-50	178	0.60		204-778
141-50	141	0.60		204-741	179-50	179	0.60		204-779
142-50	142	0.60		204-742	180-50	180	0.60		204-780

For more sizes please contact our sales team

All dimensions in mm unless stated otherwise

If a dimension is critical to your application please contact our sales department for confirmation.

Please note : errors and omissions excepted.

When ordering please specify material

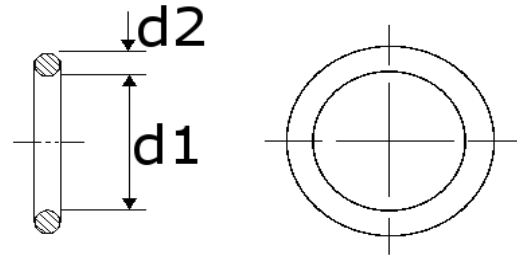

## O-Rings: European (German) Metric Range

Items marked \* are suitable for dynamic applications

APL Code	d1	Tolerance on d1 +/-	d2	Dowty Ref	APL Code	d1	Tolerance on d1 +/-	d2	Dowty Ref
181-50	181	0.80		204-781	219-50	219	0.80		204-819
182-50	182	0.80		204-782	220-50	220	0.80		204-820
183-50	183	0.80		204-783	221-50	221	0.80		204-821
184-50	184	0.80		204-784	222-50	222	0.80		204-822
185-50	185	0.80		204-785	223-50	223	0.80		204-823
186-50	186	0.80		204-786	224-50	224	0.80		204-824
187-50	187	0.80		204-787	225-50	225	0.80		204-825
188-50	188	0.80		204-788	226-50	226	0.80		204-826
189-50	189	0.80		204-789	227-50	227	0.80		204-827
190-50	190	0.80		204-790	228-50	228	0.80		204-828
191-50	191	0.80		204-791	229-50	229	0.80		204-829
192-50	192	0.80		204-792	230-50	230	0.80		204-830
193-50	193	0.80		204-793	231-50	231	0.80		204-831
194-50	194	0.80		204-794	232-50	232	0.80		204-832
195-50	195	0.80		204-795	233-50	233	0.80		204-833
196-50	196	0.80		204-796	234-50	234	0.80		204-834
197-50	197	0.80		204-797	235-50	235	0.80		204-835
198-50	198	0.80		204-798	236-50	236	0.80		204-836
199-50	199	0.80	5.0	204-799	237-50	237	0.80	5.0	204-837
200-50	200	0.80	+/- 0.12	204-800	238-50	238	0.80	+/- 0.12	204-838
201-50	201	0.80		204-801	239-50	239	0.80		204-839
202-50	202	0.80		204-802	240-50	240	0.80		204-840
203-50	203	0.80		204-803	241-50	241	0.80		204-841
204-50	204	0.80		204-804	242-50	242	0.80		204-842
205-50	205	0.80		204-805	243-50	243	0.80		204-843
206-50	206	0.80		204-806	244-50	244	0.80		204-844
207-50	207	0.80		204-807	245-50	245	0.80		204-845
208-50	208	0.80		204-808	246-50	246	0.80		204-846
209-50	209	0.80		204-809	247-50	247	0.80		204-847
210-50	210	0.80		204-810	248-50	248	0.80		204-848
211-50	211	0.80		204-811	249-50	249	0.80		204-849
212-50	212	0.80		204-812	250-50	250	0.80		204-850
213-50	213	0.80		204-813	251-50	251	1.00		204-851
214-50	214	0.80		204-814	252-50	252	1.00		204-852
215-50	215	0.80		204-815	253-50	253	1.00		204-853
216-50	216	0.80		204-816	254-50	254	1.00		204-854
217-50	217	0.80		204-817	255-50	255	1.00		204-855
218-50	218	0.80		204-818	256-50	256	1.00		204-856

For more sizes please contact our sales team

All dimensions in mm unless stated otherwise

If a dimension is critical to your application please contact our sales department for confirmation.

Please note : errors and omissions excepted.

When ordering please specify material



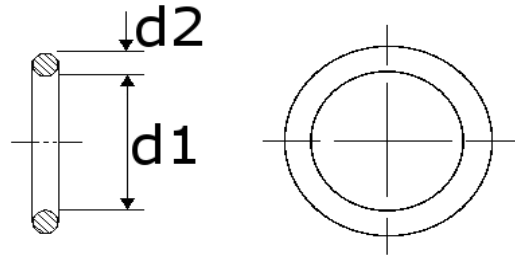

## O-Rings: European (German) Metric Range

Items marked \* are suitable for dynamic applications

APL Code	d1	Tolerance on d1 +/-	d2	Dowty Ref	APL Code	d1	Tolerance on d1 +/-	d2	Dowty Ref
257-50	257	1.00		204-857	295-50	295	1.00		204-895
258-50	258	1.00		204-858	296-50	296	1.00		204-896
259-50	259	1.00		204-859	297-50	297	1.00		204-897
260-50	260	1.00		204-860	298-50	298	1.00		204-898
261-50	261	1.00		204-861	299-50	299	1.00		204-899
262-50	262	1.00		204-862	300-50	300	1.00		204-900
263-50	263	1.00		204-863	301-50	301	1.50		204-901
264-50	264	1.00		204-864	302-50	302	1.50		204-902
265-50	265	1.00		204-865	303-50	303	1.50		204-903
266-50	266	1.00		204-866	304-50	304	1.50		204-904
267-50	267	1.00		204-867	305-50	305	1.50		204-905
268-50	268	1.00		204-868	306-50	306	1.50		204-906
269-50	269	1.00		204-869	307-50	307	1.50		204-907
270-50	270	1.00		204-870	308-50	308	1.50		204-908
271-50	271	1.00		204-871	309-50	309	1.50		204-909
272-50	272	1.00		204-872	310-50	310	1.50		204-910
273-50	273	1.00		204-873	311-50	311	1.50		204-911
274-50	274	1.00		204-874	312-50	312	1.50		204-912
275-50	275	1.00	5.0	204-875	313-50	313	1.50	5.0	204-913
276-50	276	1.00	+/- 0.12	204-876	314-50	314	1.50	+/- 0.12	204-914
277-50	277	1.00		204-877	315-50	315	1.50		204-915
278-50	278	1.00		204-878	316-50	316	1.50		204-916
279-50	279	1.00		204-879	317-50	317	1.50		204-917
280-50	280	1.00		204-880	318-50	318	1.50		204-918
281-50	281	1.00		204-881	319-50	319	1.50		204-919
282-50	282	1.00		204-882	320-50	320	1.50		204-920
283-50	283	1.00		204-883	321-50	321	1.50		204-921
284-50	284	1.00		204-884	322-50	322	1.50		204-922
285-50	285	1.00		204-885	323-50	323	1.50		204-923
286-50	286	1.00		204-886	324-50	324	1.50		204-924
287-50	287	1.00		204-887	325-50	325	1.50		204-925
288-50	288	1.00		204-888	326-50	326	1.50		204-926
289-50	289	1.00		204-889	327-50	327	1.50		204-927
290-50	290	1.00		204-890	328-50	328	1.50		204-928
291-50	291	1.00		204-891	329-50	329	1.50		204-929
292-50	292	1.00		204-892	330-50	330	1.50		204-930
293-50	293	1.00		204-893	331-50	331	1.50		204-931
294-50	294	1.00		204-894	332-50	332	1.50		204-932

For more sizes please contact our sales team

All dimensions in mm unless stated otherwise

If a dimension is critical to your application please contact our sales department for confirmation.

Please note : errors and omissions excepted.

When ordering please specify material

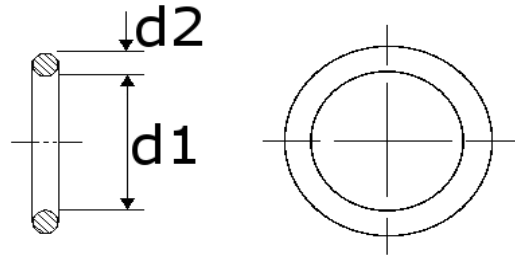

## O-Rings: European (German) Metric Range

Items marked \* are suitable for dynamic applications

APL Code	d1	Tolerance on d1 +/-	d2	Dowty Ref	APL Code	d1	Tolerance on d1 +/-	d2	Dowty Ref
333-50	333	1.50	5.0 +/- 0.12	204-933	371-50	371	1.50	5.0 +/- 0.12	204-971
334-50	334	1.50		204-934	372-50	372	1.50		204-972
335-50	335	1.50		204-935	373-50	373	1.50		204-973
336-50	336	1.50		204-936	374-50	374	1.50		204-974
337-50	337	1.50		204-937	375-50	375	1.50		204-975
338-50	338	1.50		204-938	376-50	376	1.50		204-976
339-50	339	1.50		204-939	377-50	377	1.50		204-977
340-50	340	1.50		204-940	378-50	378	1.50		204-978
341-50	341	1.50		204-941	379-50	379	1.50		204-979
342-50	342	1.50		204-942	380-50	380	1.50		204-980
343-50	343	1.50		204-943	381-50	381	1.50		204-981
344-50	344	1.50		204-944	382-50	382	1.50		204-982
345-50	345	1.50		204-945	383-50	383	1.50		204-983
346-50	346	1.50		204-946	384-50	384	1.50		204-984
347-50	347	1.50		204-947	385-50	385	1.50		204-985
348-50	348	1.50		204-948	386-50	386	1.50		204-986
349-50	349	1.50		204-949	387-50	387	1.50		204-987
350-50	350	1.50		204-950	388-50	388	1.50		204-988
351-50	351	1.50		204-951	389-50	389	1.50		204-989
352-50	352	1.50		204-952	390-50	390	1.50		204-990
353-50	353	1.50		204-953	391-50	391	1.50		204-991
354-50	354	1.50		204-954	392-50	392	1.50		204-992
355-50	355	1.50		204-955	393-50	393	1.50		204-993
356-50	356	1.50		204-956	394-50	394	1.50		204-994
357-50	357	1.50		204-957	395-50	395	1.50		204-995
358-50	358	1.50		204-958	396-50	396	1.50		204-996
359-50	359	1.50		204-959	397-50	397	1.50		204-997
360-50	360	1.50		204-960	398-50	398	1.50		204-998
361-50	361	1.50		204-961	399-50	399	1.50		204-999
362-50	362	1.50		204-962					
363-50	363	1.50		204-963					
364-50	364	1.50		204-964					
365-50	365	1.50		204-965					
366-50	366	1.50		204-966					
367-50	367	1.50		204-967					
368-50	368	1.50		204-968					
369-50	369	1.50		204-969					
370-50	370	1.50	204-970						

For more sizes please contact our sales team

All dimensions in mm unless stated otherwise

If a dimension is critical to your application please contact our sales department for confirmation.

Please note : errors and omissions excepted.

When ordering please specify material