

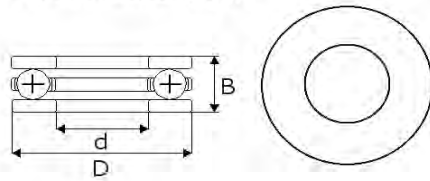

Type F / without groove

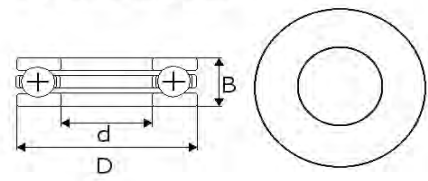

Type B / with groove



**Single Row Radial  
Miniature Three Part Thrust  
Metric**

Primary Dimensions			Bearing Code	
d	D	B	Chrome Steel	Stainless Steel
mm				
2	6	3	F 2-6	-
4	9	4	F 4-9	-
4	10	4.5	F 4-10	-
5	11	4.5	F 5-11	-
6	12	4.5	F 6-12	-
7	15	5	F 7-15	-
8	16	5	F 8-16	-
9	17	5	F 9-17	-
10	18	5.5	F 10-18	-
3	8	3.5	B 3	SB 3
4	10	4	B 4	SB 4
5	12	4	B 5	SB 5
6	14	5	B 6	SB 6
7	17	6	B 7	SB 7
8	19	7	B 8	SB 8
9	20	7	B 9	SB 9

If a dimension is critical to your application please contact our sales department for confirmation.  
Please note : errors and omissions excepted.