

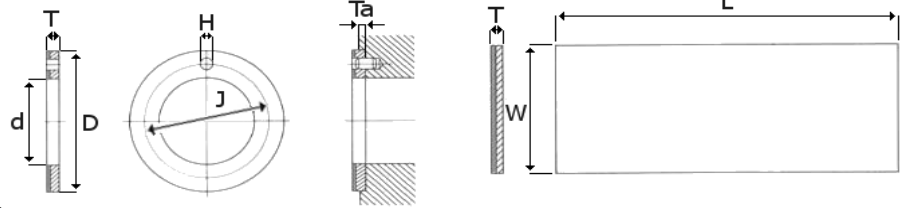

**PTFE Lined Steel
Thrust Washers & Strip
Metric**



All Dimensions in mm unless stated otherwise

Part no	d	D	T	H	J	Ta
WC08DU	10.00	20.00	1.50	NO HOLE		0.95
	10.25	19.75	1.45			1.20
WC10DU	12.00	24.00	1.50	1.625	18.12	0.95
	12.25	23.75	1.45	1.875	17.88	1.20
WC12DU	14.00	26.00	1.50	2.125	22.12	0.95
	14.25	25.75	1.45	2.375	19.88	1.20
WC14DU	16.00	30.00	1.50	2.125	22.12	0.95
	16.25	29.75	1.45	2.375	21.88	1.20
WC16DU	18.00	32.00	1.50	2.125	25.12	0.95
	18.25	31.75	1.45	2.375	24.88	1.20
WC18DU	20.00	36.00	1.50	3.125	28.12	0.95
	20.25	35.75	1.45	3.375	27.88	1.20
WC20DU	22.00	38.00	1.50	3.125	30.12	0.95
	22.25	37.75	1.45	3.375	29.88	1.20
WC22DU	24.00	42.00	1.50	3.125	33.12	0.95
	24.25	41.75	1.45	3.375	32.88	1.20
WC24DU	26.00	44.00	1.50	3.125	35.12	0.95
	26.25	43.75	1.45	3.375	34.88	1.20
WC25DU	28.00	48.25	1.50	4.125	38.12	0.95
	28.25	47.75	1.45	4.375	37.88	1.20
WC30DU	32.00	54.00	1.50	4.125	43.12	0.95
	32.25	53.75	1.45	4.375	42.88	1.20
WC35DU	38.00	62.00	1.50	4.125	50.12	0.95
	38.25	61.75	1.45	4.375	49.88	1.20
WC40DU	42.00	66.00	1.50	4.125	54.12	0.95
	42.25	65.75	1.45	4.375	53.88	1.20
WC45DU	48.00	74.00	2.00	4.125	61.12	1.45
	48.25	73.75	1.95	4.375	60.88	1.70
WC50DU	52.00	78.00	2.00	4.125	65.12	1.45
	52.25	77.75	1.95	4.375	64.88	1.70
WC60DU	62.00	90.00	2.00	4.125	76.12	1.45
	62.25	89.75	1.95	4.375	75.88	1.70

Metric Sizes In Lengths (L) of Approx. 500mm		
Part No.	T +0/-0.04 mm	W mm
075150DU	0.75	150
100200DU	1.00	200
150240DU	1.50	240
200240DU	2.00	240
250240DU	2.50	240
306240DU	3.06	240

Please note : errors and omissions excepted.



**PTFE Lined Steel
Thrust Washers & Strip**

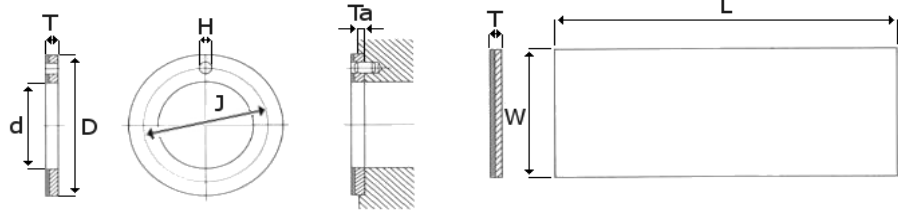

Part no

All Dimensions in inches unless stated otherwise

Part no	d	D	T	H	J	Ta
DU06	0.500	0.875	0.063	0.067	0.692	0.040
	0.510	0.865	0.061	0.077	0.682	0.050
DU07	0.562	1.000	0.063	0.067	0.786	0.040
	0.572	0.990	0.061	0.077	0.776	0.050
DU08	0.625	1.125	0.063	0.099	0.880	0.040
	0.635	1.115	0.061	0.109	0.870	0.050
DU09	0.687	1.187	0.063	0.099	0.942	0.040
	0.697	1.177	0.061	0.109	0.932	0.050
DU10	0.750	1.250	0.063	0.099	1.005	0.040
	0.760	1.240	0.061	0.109	0.885	0.050
DU11	0.812	1.375	0.063	0.099	1.009	0.040
	0.822	1.365	0.061	0.109	1.089	0.050
DU12	0.875	1.500	0.063	0.130	1.192	0.040
	0.885	1.490	0.061	0.140	1.182	0.050
DU14	1.000	1.750	0.063	0.130	1.380	0.040
	1.010	1.740	0.061	0.140	1.370	0.050
DU16	1.125	2.000	0.063	0.161	1.567	0.040
	1.135	1.990	0.061	0.171	1.557	0.050
DU18	1.250	2.125	0.063	0.161	1.692	0.040
	1.260	2.115	0.061	0.171	1.682	0.050
DU20	1.375	2.250	0.063	0.161	1.817	0.040
	1.385	2.240	0.061	0.171	1.807	0.050
DU22	1.500	2.500	0.063	0.192	2.005	0.040
	1.510	2.490	0.061	0.202	1.995	0.050
DU24	1.625	2.625	0.063	0.192	2.130	0.040
	1.635	2.615	0.061	0.202	2.120	0.050
DU26	1.750	2.750	0.063	0.192	2.255	0.040
	1.760	2.740	0.061	0.202	2.245	0.050
DU28	2.000	3.000	0.093	0.192	2.505	0.070
	2.010	2.990	0.091	0.202	2.495	0.080
DU30	2.125	3.125	0.093	0.192	2.630	0.070
	2.135	3.115	0.091	0.202	2.620	0.080
DU32	2.250	3.250	0.093	0.192	2.755	0.070
	2.260	3.240	0.091	0.202	2.745	0.080

Imperial Sizes In Lengths (L) of 18in		
Group No.	T	W
0	0.0277-0.0293	2.75
1	0.0430-0.0447	4
2	0.0586-0.0602	4
3	0.0740-0.0756	4
4	0.0897-0.0913	4
5	0.1190-0.1210	4

Please note : errors and omissions excepted.