

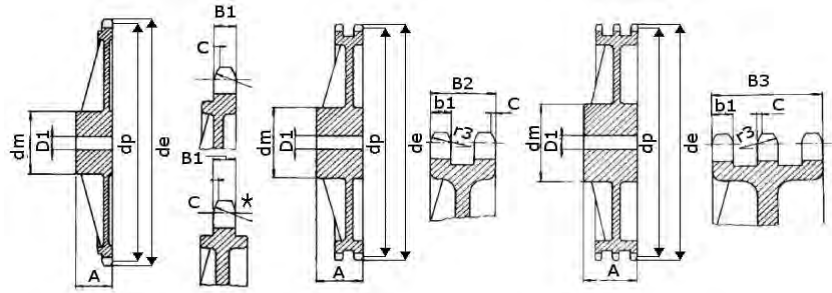

## Sprockets British Standard 3/8" x 7/32" Cast Iron



No. teeth	de	dp	Simplex			Duplex			Triplex		
			dm	D1	A	dm	D1	A	dm	D1	A
38	119.5	115.35	70	19	32	80	19	40	90	23	56
45	140.7	136.55	70	19	32	80	19	40	90	23	56
57	176.9	172.91	70	19	32	80	19	40	90	23	56
76	234.9	230.49	70	19	32	80	19	40	100	23	56
*95	292.5	288.08	80	19	40	90	19	45	100	23	56
*114	349.6	345.68	80	19	40	90	19	45	100	23	56
*150	459.2	454.82	90	23	45	100	23	50	125	23	60

Tooth Radius  $r_3 = 10$

Radius size C = 1.0

Tooth width  $B_1 = 5.3$

Tooth width  $b_1 = 5.2$

Tooth width  $B_2 = 15.4$

Tooth width  $B_3 = 25.6$

de = outside diameter

dp = pitch diameter

\* Simplex sprockets with rim reinforcement on both sides

All dimensions in mm

Intermediate sizes & special sprockets to drawing up to 1000mm diameter

Standard : to DIN 8187 ISO/R 606

Please note : All dimensions including bore sizes subject to change.

If a dimension is critical to your application please contact our sales department for confirmation.

For special sprockets or reworked sprockets please contact our sales department.

Please note : errors and omissions excepted.



## Sprockets British Standard 1/2" x 5/16" Cast Iron

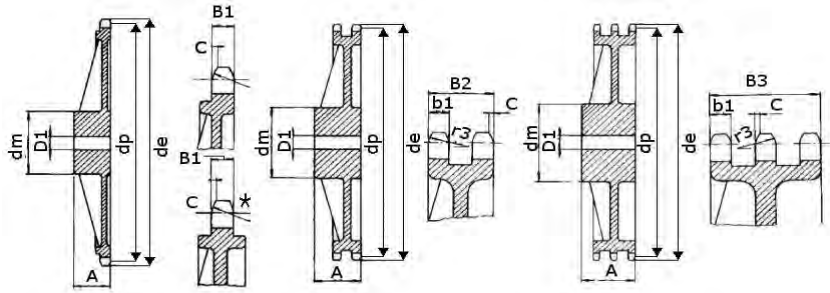

No. teeth	de	dp	Simplex			Duplex			Triplex		
			dm	D1	A	dm	D1	A	dm	D1	A
38	119.5	115.35	70	19	32	80	19	40	90	23	56
45	140.7	136.55	70	19	32	80	19	40	90	23	56
57	176.9	172.91	70	19	32	80	19	40	90	23	56
76	234.9	230.49	70	19	32	80	19	40	100	23	56
95	292.5	288.08	80	19	40	90	19	45	100	23	56
114	349.6	345.68	80	19	40	90	19	45	100	23	56
150	459.2	454.82	90	23	45	100	23	50	125	23	60

Tooth Radius  $r_3 = 13$

Radius size C = 1.3

Tooth width  $B_1 = 7.2$

Tooth width  $b_1 = 7.0$

Tooth width  $B_2 = 21.0$

Tooth width  $B_3 = 34.9$

de = outside diameter

dp = pitch diameter

All dimensions in mm

Intermediate sizes & special sprockets to drawing up to 1000mm diameter

Standard : to DIN 8187 ISO/R 606

Please note : All dimensions including bore sizes subject to change.

If a dimension is critical to your application please contact our sales department for confirmation.

For special sprockets or reworked sprockets please contact our sales department.

Please note : errors and omissions excepted.



**Sprockets British Standard  
5/8" x 3/8"  
Cast Iron**

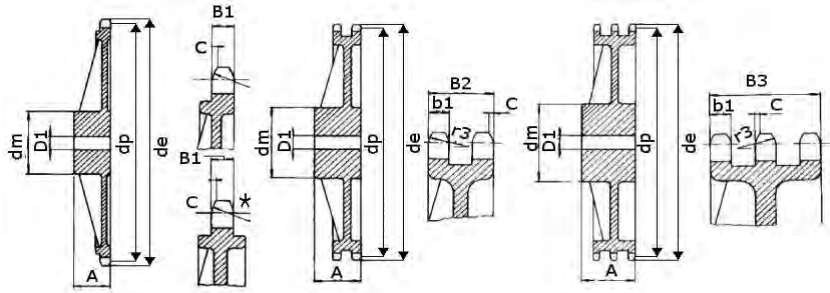

No. teeth	de	dp	Simplex			Duplex			Triplex		
			dm	D1	A	dm	D1	A	dm	D1	A
38	199.2	192.24	80	19	40	100	29	50	100	31	60
45	235	227.58	80	19	40	100	29	50	100	31	60
57	296	288.18	90	23	45	100	29	56	100	31	63
*76	392.1	384.16	90	23	50	100	29	63	110	34	67
*95	488.5	480.14	100	23	56	110	29	63	125	34	70
*114	584.1	576.13	100	23	56	125	29	70	125	34	80

Tooth Radius  $r_3 = 16$

Radius size C = 1.6

Tooth width  $B_1 = 9.1$

Tooth width  $b_1 = 9.0$

Tooth width  $B_2 = 25.5$

Tooth width  $B_3 = 42.1$

de = Outside Diameter

dp = Pitch Diameter

\* Simplex sprockets with rim reinforcement on both sides

All dimensions in mm

Intermediate sizes & special sprockets to drawing up to 1000mm diameter

Standard : to DIN 8187 ISO/R 606

Please note : All dimensions including bore sizes subject to change.

If a dimension is critical to your application please contact our sales department for confirmation.

For special sprockets or reworked sprockets please contact our sales department.

Please note : errors and omissions excepted.



## Sprockets British Standard 3/4 x 7/16 Cast Iron

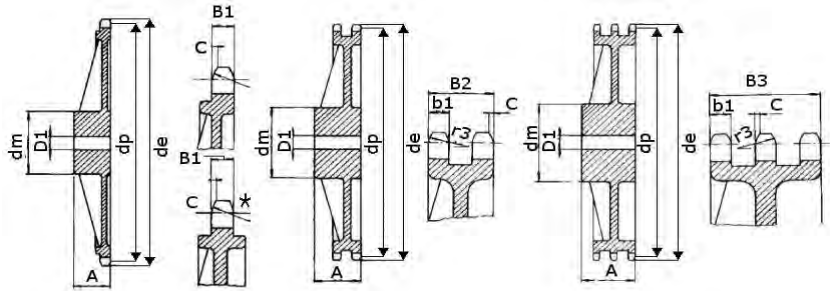

No. teeth	de	dp	Simplex			Duplex			Triplex		
			dm	D1	A	dm	D1	A	dm	D1	A
38	239	230.69	100	23	56	110	29	63	140	31	70
45	282.5	273.1	100	23	56	110	29	63	140	31	70
57	354	345.81	100	29	56	120	29	63	140	39	70
76	469.9	460.99	100	29	56	135	29	63	160	39	75
*95	585.1	576.17	100	29	65	135	29	70	170	39	82
*114	700.6	691.36	100	29	65	135	44	70	170	49	82

Tooth Radius  $r_3 = 19$

Radius size  $C = 2$

Tooth width  $B_1 = 11.1$

Tooth width  $b_1 = 10.8$

Tooth width  $B_2 = 30.3$

Tooth width  $B_3 = 49.8$

de = Outside Diameter

dp = Pitch Diameter

\* Simplex sprockets with rim reinforcement on both sides

All dimensions in mm

Intermediate sizes & special sprockets to drawing up to 1000mm diameter

Standard : to DIN 8187 ISO/R 606

Please note : All dimensions including bore sizes subject to change.

If a dimension is critical to your application please contact our sales department for confirmation.

For special sprockets or reworked sprockets please contact our sales department.

Please note : errors and omissions excepted.



## Sprockets British Standard 1" x 17.02mm Cast Iron

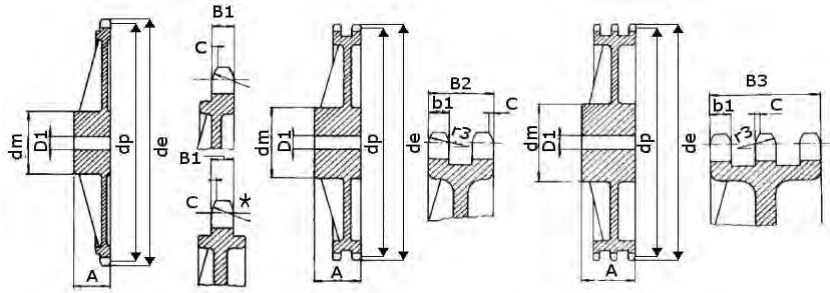

No. teeth	de	dp	Simplex			Duplex			Triplex		
			dm	D1	A	dm	D1	A	dm	D1	A
30	254	243	110	29	65	125	39	75	145	39	90
38	320	307.59	110	29	65	140	39	75	160	44	100
45	377	364.13	125	29	70	148	39	75	160	44	100
57	474	461.08	125	34	70	160	39	90	165	44	100
76	627	614.65	140	34	80	175	39	95	200	44	110
95	781	768.22	140	39	80	175	44	95	200	49	110
*114	933	921.81	150	39	80	175	44	95	200	49	115

Tooth Radius  $r_3 = 26$

Radius size C = 2.5

Tooth width  $B_1 = 16.2$

Tooth width  $b_1 = 15.8$

Tooth width  $B_2 = 47.7$

Tooth width  $B_3 = 79.6$

de = Outside Diameter

dp = Pitch Diameter

\* Simplex sprockets with rim reinforcement on both sides

All dimensions in mm

Intermediate sizes & special sprockets to drawing up to 1000mm diameter

Standard : to DIN 8187 ISO/R 606

Please note : All dimensions including bore sizes subject to change.

If a dimension is critical to your application please contact our sales department for confirmation.

For special sprockets or reworked sprockets please contact our sales department.

Please note : errors and omissions excepted.



## Sprockets British Standard 1 1/4" x 3/4" Cast Iron

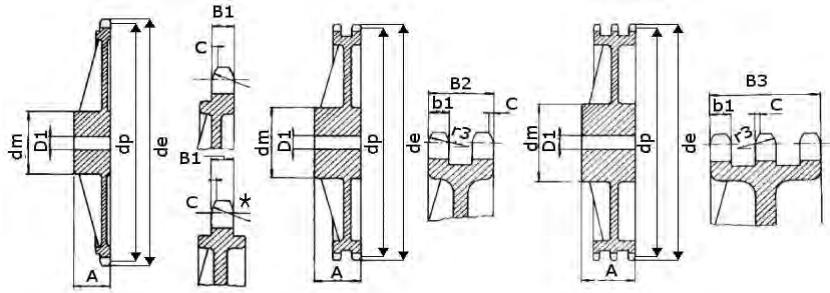

No. teeth	de	dp	Simplex			Duplex			Triplex		
			dm	D1	A	dm	D1	A	dm	D1	A
30	318.9	303.75	115	34	70	130	39	80	-	-	-
38	399.6	384.49	125	34	70	140	44	90	170	55	110
45	470.3	455.17	125	34	70	140	44	90	-	-	-
57	591.5	576.36	135	39	80	160	49	100	180	62	125
76	783.5	768.32	140	49	90	180	55	100	-	-	-

Tooth Radius  $r_3 = 32$

Radius size C = 3.5

Tooth width  $B_1 = 18.5$

Tooth width  $b_1 = 18.2$

Tooth width  $B_2 = 54.6$

Tooth width  $B_3 = 91.0$

de = Outside Diameter

dp = Pitch Diameter

\* Simplex sprockets with rim reinforcement on both sides

All dimensions in mm

Intermediate sizes & special sprockets to drawing up to 1000mm diameter

Standard : to DIN 8187 ISO/R 606

Please note : All dimensions including bore sizes subject to change.

If a dimension is critical to your application please contact our sales department for confirmation.

For special sprockets or reworked sprockets please contact our sales department.

Please note : errors and omissions excepted.



## Sprockets British Standard 1 1/2" x 1" Cast Iron

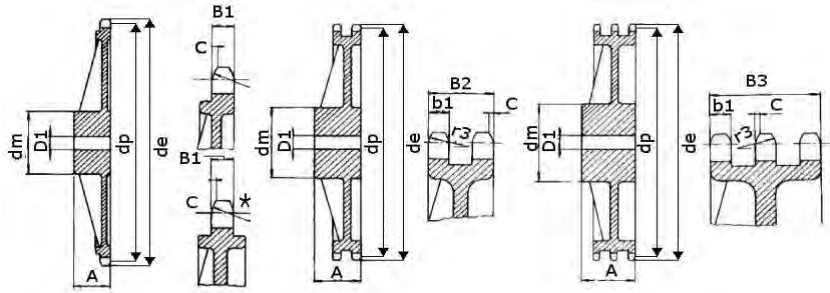

No. teeth	de	dp	Simplex			Duplex			Triplex		
			dm	D1	A	dm	D1	A	dm	D1	A
30	379.5	364.5	130	39	85	-	-	-	-	-	-
38	476.2	461.39	140	44	90	180	44	100	200	62	150
45	581.2	546.2	140	44	90	-	-	-	-	-	-
57	706.5	691.63	160	44	100	200	54	110	200	62	150
76	936.9	921.98	170	44	100	220	54	120	250	69	150
95	1172	1152.3	220	160	120	-	-	-	270	50	200
114	1402.5	1382.7	220	70	110	290	60	180	-	-	-

Tooth Radius  $r_3 = 38$

Radius size C = 4

Tooth width  $B_1 = 24.1$

Tooth width  $b_1 = 23.6$

Tooth width  $B_2 = 72.0$

Tooth width  $B_3 = 120.3$

de = Outside Diameter

dp = Pitch Diameter

\* Simplex sprockets with rim reinforcement on both sides

All dimensions in mm

Intermediate sizes & special sprockets to drawing up to 1000mm diameter

Standard : to DIN 8187 ISO/R 606

Please note : All dimensions including bore sizes subject to change.

If a dimension is critical to your application please contact our sales department for confirmation.

For special sprockets or reworked sprockets please contact our sales department.

Please note : errors and omissions excepted.